

CHANGSHI POWER TOOLS

GB/T19001-2016 idt ISO9001:2015
质量管理体系认证
CHINA

宁波长实电力机具制造有限公司
NINGBO CHANGSHI ELECTRIC MACHINERY MANUFACTURING CO.,LTD.

地址(ADD): 中国浙江宁波奉化西坞

Xiwu Street, Fenghua District, Ningbo, China

邮编(P.C.): 315504

电话(TEL): +86-574-88685199 88685198 88685196

传真(FAX): +86-574-88685197 88685195

手机(CELL): 015974877775

网址: <https://www.csstringingtools.com/>



精品人品同在
诚信创新永恒



CHANGSHI POWER

TOOLS 宁波长实电力机具制造有限公司



NINGBO CHANGSHI ELECTRIC
MACHINERY MANUFACTURING CO.,LTD.

COMPANY INTRODUCTION

公司简介

宁波长实电力机具制造有限公司
NINGBO CHANGSHI POWER TOOLS MANUFACTURING CO.,LTD.

CHANGSHI POWER

宁波长实电力机具制造有限公司位于风景秀丽的旅游胜地宁波市奉化区。是全国电力系统送电运行专业网成员企业，是集研发、生产与销售电力施工器具、MC尼龙制品于一体的综合型企业，企业通过了:GBIT19001-2016idt1S09001:2015质量体系认证。

电力机具主要产品有：机动绞磨系列、放线滑车系列、起重滑车系列、紧线系列、卡线器系列、放线架系列、抱杆系列、剪切系列、压接系列及其它检修工具等系列600余种产品。MC尼龙制品主要有尼龙轮、尼龙齿轮、尼龙棒、尼龙板等,并可根据客户的要求订做各种尼龙制品，其中制品具有强度高、抗冲击、耐磨、耐腐蚀、耐老化、减震、自润滑等特点。可替代铜、铝、合金等金属制件。广泛用于石油、冶金、建筑、纺织、船舶、矿山、起重电力机具等。我们的产品畅销全国各地，部分产品出口国际市场。企业聘请富有实践经验的专家为技改和生产作后盾。各种优质电力工具，产品深受电力用户的厚爱。

公司秉承了电力机具设计制造经验，强化了企业在市场上的竞争力，推进了企业的创新和发展。时刻关注市场的发展动态，及时获取市场信息，把握机遇，使客商买得放心，用得满意。并以市场为导向，以丰富的管理经验，积极开发新产品新项目。

Ningbo Changshi Electric Machinery Manufacturing Co.,Ltd. is located in Fenghua District of Ningbo City, a scenic tourist destination. It is a member enterprise of the national power system power transmission operation professional network, and is a comprehensive enterprise integrating research and development, production and sales of power construction appliances and MC nylon products. The enterprise has passed the GBIT19001-2016idt1S09001:2015 quality system certification.

The main products of electric machinery are: motor grinding series, pay-off block series, lifting block series, wire series, card series, pay-off rack series, pole series, shear series, crimping series and other maintenance tools series more than 600 kinds of products. MC nylon products mainly include nylon wheel, nylon gear, nylon rod, nylon plate, etc., and can be customized according to customer requirements of various nylon products, which have high strength, impact resistance, wear resistance, corrosion resistance, aging resistance, shock absorption, self-lubrication and other characteristics. Can replace copper, aluminum, alloy and other metal parts. Widely used in petroleum, metallurgy, construction, textiles, ships, mines, lifting electric machinery and so on. Our products sell well all over the country, and some products are exported to the international market. The company employs experts with practical experience to support technical transformation and production. A variety of high-quality power tools, products by the power users love.

Adhering to the design and manufacturing experience of electric machinery, the company has strengthened the competitiveness of the enterprise in the market and promoted the innovation and development of the enterprise. Always pay attention to the development of the market, timely access to market information, seize opportunities, so that merchants can buy at ease, with satisfaction. And market-oriented, with rich management experience, actively develop new products and new projects.

机动绞磨 Engine Powered Winch	01-04
放线滑车 Stringing Blocks	05-13
起重滑车 Hoisting Tackles	14-18
电缆滑车 Cable Rollers	19-24
特种滑车 Special Blocks	25-29
卡线器 Grippers	30-33
连接器提线器 Connectors and Lifters	34-40
放线架牵引绳 Reel Stands and Traction Ropes	41-45
葫芦紧线器 Chain Hoists and Tighteners	46-49
抱杆飞车 Gin Poles and Inspection Trolleys	50-53
剥皮剪切 Peelers and Cutters	54-56
牵引设备 Traction Equipments	57-58
液压工具 Hydraulic Tools	59-68
五金工具 Hardware Tools	69-70
安全工具 Safety Tools	71-76
辅助工具 Auxiliary Tools	77-82
常用参数 Common parameters	83-90

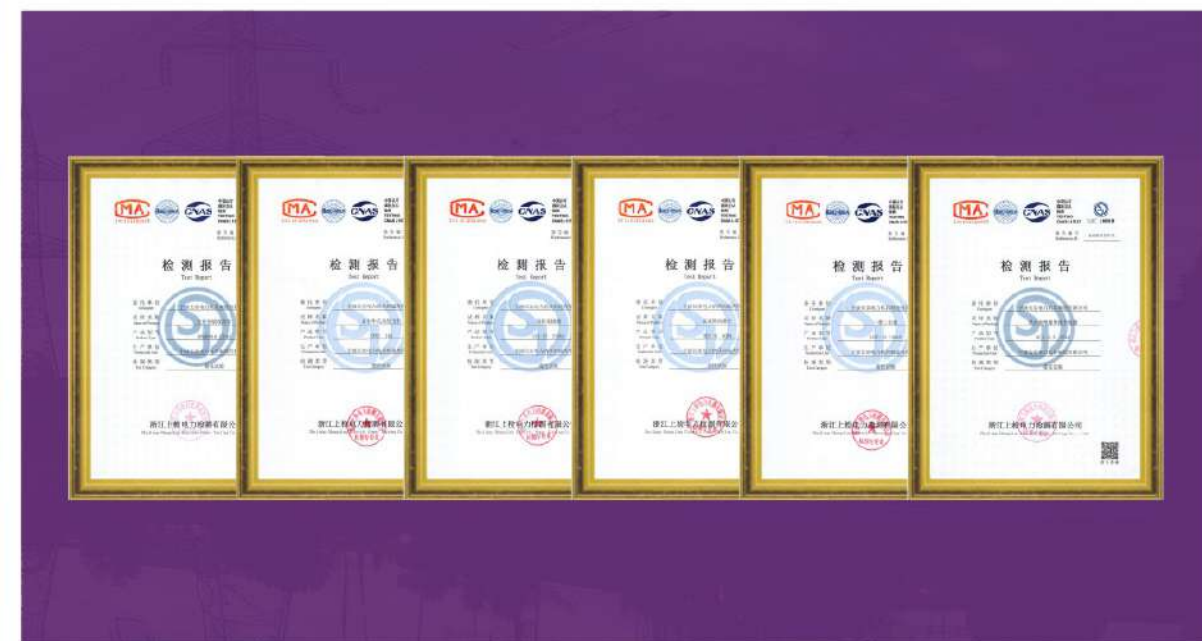

■ 汽油机动绞磨机 / Gasoline Engine Powered Winch

型号 Model	ZJ-QXM-80/5.5		
发动机功率(KW) Engine power(kw)	11	额定牵引力(KN) Rated Traction(kn)	80
整机重量(KG) Whole Weight(kg)	245	外形尺寸(MM) Shape Size(mm)	1350*600*580
档位 File Location	牵引力 Traction (kn)	磨芯速度 Core Speed (turn/min)	线速度 Linear Velocity (m/min)
正快档 Fast File	30	15	15
正慢档 Slow	80	5.5	5.5
反慢档 Anti-slow	80	5.5	5.5
反快档 Anti-fast File	30	15	15

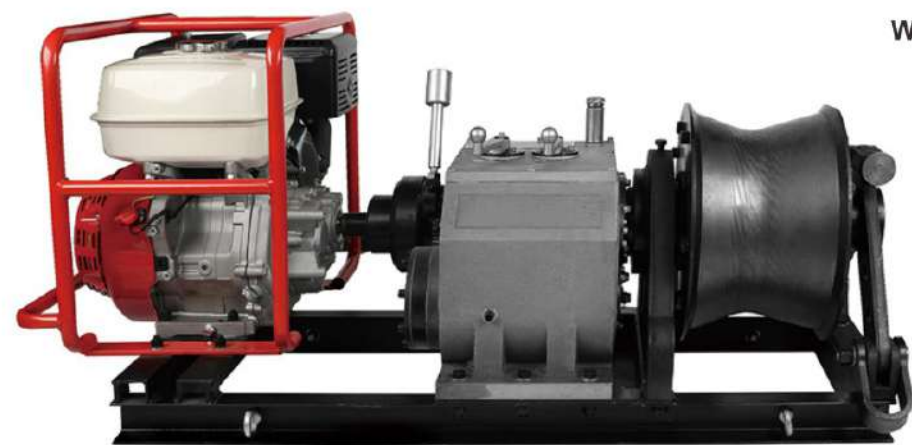

WITH HONDA
配本田

说明 / Explain

- ZJ-QXM-80/5.5 汽油机动绞磨机为通用型工程机械，是一种野外无电源施工中理想的牵引吊装机械设备。
- 主要用于电力/邮电/电信/林场/煤矿/码头等施工中的组立杆塔/牵引/吊装重物。
- ZJ-QXM-80 / 5.5 gasoline motor grinder is a general engineering machine and is an ideal traction lifting mechanical equipment in the field without power supply construction.
- It is mainly used for erecting pole towers/towing/lifting heavy objects in power/post/telecommunication/forest farm/coal mine/wharf construction.



■ 双卷筒机动绞磨机 / Double-Drums Engine Powered Winch

型号 Model	ZJ-QXM-50/6		
发动机功率 Engine power(KW)	9.6	额定牵引力 Rated Traction(KN)	50
整机重量 Whole Weight(KG)	280	适合钢丝 Suitable For Wire(MM)	Φ16-Φ18
档位 File Location	快速 Quick	中速 Intermediate Speed	慢速 Low Speed
牵引力 Traction(KN)	10	30	50
牵引速度 Traction speed(m/min)	20	10	6



WITH HONDA
配本田

说明 / Explain

- ZJ-QXM-50/6 双筒汽油机动绞磨机为通用型工程机械，是一种野外无电源施工中理想的牵引吊装机械设备。
- 主要用于电力/邮电/电信/林场/煤矿/码头等施工中的组立杆塔/牵引/吊装重物。
- ZJ-QXM-50 / 6 double-barrel gasoline motor grinder is a general engineering machine and is an ideal traction lifting mechanical equipment in the field without power supply construction.
- It is mainly used for erecting pole towers/towing/lifting heavy objects in power/post/telecommunication/forest farm/coal mine/wharf construction.

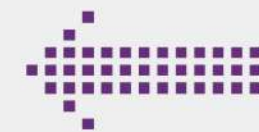

■ 机动绞磨机 / Engine Powered Winch

型号 Model	ZJ-QXM-30/7 汽油机 Gasoline engine			ZJ-QXM-30/7 柴油机 Diesel engine		
发动机功率(KW) Engine power(kw)	3.7			4.0		
整机重量(KG) Whole Weight(kg)	100			100		
额定牵引力(KN) Rated Traction(kn)	30			30		
外形尺寸(MM) Shape Size(mm)	750*420*530			750*420*530		
File 档位	牵引力 Traction(kn)	磨芯速度 Core Speed (turn/min)	线速度 Linear Velocity (m/min)	牵引力 Traction(kn)	磨芯速度 Core Speed (turn/min)	线速度 Linear Velocity (m/min)
Fast File 快档	18	20	12	18	20	12
Slow 慢档	30	13	7	30	13	7
Reverse file 反档	30	13	7	30	13	7

WITH HONDA
配本田



WITH HONDA
配本田



MATCHING DIESEL ENGINE
配柴油机



■ 机动绞磨机 / Engine Powered Winch

型号 Model	ZJ-QXM-50/5.5 汽油机 Gasoline engine			ZJ-QXM-50/5.5 柴油机 Diesel engine		
发动机功率(KW) Engine power(kw)	5.8			6.8		
整机重量(KG) Whole Weight(kg)	138			138		
额定牵引力(KN) Rated Traction(kn)	50			50		
外形尺寸(MM) Shape Size(mm)	1250*550*560			1250*550*560		
档位 File Location	牵引力 Traction(kn)	磨芯速度 Core Speed (turn/min)	线速度 Linear Velocity (m/min)	牵引力 Traction(kn)	磨芯速度 Core Speed (turn/min)	线速度 Linear Velocity (m/min)
快 I 档 Fast I	10	53.5	30	10	53.5	30
慢 I 档 Slow I	15	32	18	15	32	18
反 I 档 Anti-I file	15	32	18	15	32	18
快 II 档 Fast II	25	21.4	12	25	21.4	12
慢 II 档 Slow II	50	9.8	5.5	50	9.8	5.5
反 II 档 Anti-II file	50	9.8	5.5	50	9.8	5.5

说明 / Explain

- ◆ ZJ-QXM-50/5.5 汽油机动绞磨机/柴油机动绞磨机为通用型工程机械，是一种野外无电源施工中理想的牵引吊装机械设备。
- ◆ 主要用于电力/邮电/电信/林场/煤矿/码头等施工中的组立杆塔/牵引/吊装重物。
- ◆ ZJ-QXM-50/5.5 gasoline motor grinder/diesel engine winch is a general-purpose construction machinery. It is an ideal traction hoisting machinery in field power-free construction.
- ◆ It is mainly used for erecting pole towers/towing/lifting heavy objects in power/post/telecommunication/forest farm/coal mine/wharf construction.

WITH YAMAHA
配雅马哈



MATCHING DIESEL ENGINE
配柴油机





■ 尼龙轮 / Nylon Sheave

产品编号 Item No.	型号规格 Model	外径 (mm) Diameter	轮宽 (mm) Width	毛坯重量 (kg) Blank weight	产品编号 Item No.	型号规格 Model	外径 (mm) Diameter	轮宽 (mm) Width	毛坯重量 (kg) Blank weight
10010	80*50	80	50	0.2	10026	270*60	270	60	1.6
10011	120*35	120	35	0.3	10027	320*60	320	60	1.9
10012	120*60	120	60	0.5	10028	320*80	320	80	2.2
10013	120*80	120	80	0.6	10029	408*80	408	80	4.1
10014	120*130	120	130	0.7	10030	408*100	408	100	4.8
10015	120*200	120	200	1.2	10050	508*75	508	75	6.0
10016	140*160	140	160	0.9	10051	508*100	508	100	7.0
10017	140*210	140	210	1.1	10052	660*100	660	100	10.0
10018	160*40	160	40	0.5	10053	660*110	660	110	12.5
10019	160*85	160	85	1.1	10054	750*110	750	110	15.0
10020	160*230	160	230	1.7	10055	822*110	822	110	18.0
10021	200*40	200	40	0.6	10056	916*110	916	110	22.0
10022	200*60	200	60	0.8	10057	916*125	916	125	25.0
10023	200*80	200	80	1.0	10058	1040*125	1040	125	32.0
10024	250*60	250	60	1.2	10059	1160*150	1160	150	41.0
10025	250*80	250	80	1.5					

■ Φ508系列放线滑车 / Φ508 Series Stringing Block

产品编号 Item No.	型号 Model	轮数 Sheave	额定负荷 (KN) Rated Load	重量 (KG) Weight	滑轮特征 Sheave Features
10101	SHD508	1	20	18	压胶铝轮 Rubber lined aluminium sheave
10102	SHS508	3	40	61	中间: 铸钢轮 导线: 压胶铝轮 Middle: cast steel sheave Conductor: rubber lined aluminium sheave
10103	SHW508	5	60	93	
10104	SHDN508	1	20	16	MC尼龙轮 MC nylon sheave
10105	SHSLN508	3	40	47	中间: MC尼龙轮 导线: 压胶铝轮 Middle: MC nylon sheave Conductor: rubber lined aluminium sheave
10106	SHWLN508	5	60	79	
10107	SHSQN508	3	40	38	MC尼龙轮 MC nylon sheave
10108	SHWQN508	5	60	70	

说明 / Explain

- ◆ 最大适用导线 LGJ400;
- ◆ 滑轮尺寸 Φ508×Φ408×75 (mm);
- ◆ 可提供 Φ508×Φ408×100 (mm) 尼龙轮。
- ◆ Maximum suitable conductor ACSR400;
- ◆ Sheave dimension (outside diameter × root diameter × sheave width) Φ508×Φ408×75 (mm);
- ◆ Sheave dimension Φ508×Φ408×100 (mm) can be customized.



Φ660系列放线滑车/Φ660 Series Stringing Block

产品编号 Item No.	型号 Model	轮数 Sheave	额定负荷 (KN) Rated Load	重量 (KG) Weight	滑轮特征 Sheave Features
10121	SHD660	1	20	30	压胶铝轮 Rubber lined aluminium sheave
10122	SHS660	3	40	100	中间: 铸钢轮 导线: 压胶铝轮 Middle: cast steel sheave Conductor: rubber lined aluminium sheave
10123	SHW660	5	60	150	
10124	SHDN660	1	20	26	MC尼龙轮 MC nylon sheave
10125	SHSLN660	3	40	86	中间: MC尼龙轮 导线: 压胶铝轮 Middle: MC nylon sheave Conductor: rubber lined aluminium sheave
10126	SHWLN660	5	60	120	
10127	SHSQN660	3	40	70	MC尼龙轮 MC nylon sheave
10128	SHWQN660	5	60	110	



说明 / Explain

- 最大适用导线 LGJ500;
- 滑轮尺寸 $\Phi 660 \times \Phi 560 \times 100$ (mm);
- 可提供 $\Phi 660 \times \Phi 560 \times 110$ (mm) 尼龙轮。
- Maximum suitable conductor ACSR500;
- Sheave dimension (outside diameter x root diameter x sheave width) $\Phi 660 \times \Phi 560 \times 100$ (mm);
- Sheave dimension $\Phi 660 \times \Phi 560 \times 110$ (mm) can be customized.

Φ822系列放线滑车 / Φ822 Series Stringing Block

产品编号 Item No.	型号 Model	轮数 Sheave	额定负荷 (KN) Rated Load	重量 (KG) Weight	滑轮特征 Sheave Features
10141	SHDN822	1	30	40	MC尼龙轮 MC nylon sheave
10142	SHSQN822	3	60	118	
10143	SHWQN822	5	120	170	
10146	SHQ822	7	120	285	中间: 铸钢轮 导线: MC尼龙轮 Middle: cast steel sheave Conductor: MC nylon sheave
10148	SHJ822	9	150	445	

说明 / Explain

- 最大适用导线 LGJ630;
- 滑轮尺寸 $\Phi 822 \times \Phi 710 \times 110$ (mm);
- 可提供压胶铝轮和压胶MC尼龙轮的导线轮。
- Maximum suitable conductor ACSR630;
- Sheave dimension (outside diameter x root diameter x sheave width) $\Phi 822 \times \Phi 710 \times 110$ (mm);
- Rubber lined MC nylon sheave for conductor can be customized.



Φ916系列放线滑车 / Φ916 Series Stringing Block

产品编号 Item No.	型号 Model	轮数 Sheave	额定负荷 (KN) Rated Load	重量 (KG) Weight	滑轮特征 Sheave Features
10151	SHDN916	1	50	51	MC尼龙轮 MC nylon sheave
10152	SHSQN916	3	75	120	
10153	SHWQN916	5	150	200	

说明 / Explain

- 最大适用导线 LGJ720;
- 滑轮尺寸 $\Phi 916 \times \Phi 800 \times 110$ (mm), 可提供 $\Phi 916 \times \Phi 800 \times 125$ (mm) 尼龙轮;
- 也可提供压铸钢中轮。
- Maximum suitable conductor ACSR720;
- Sheave dimension (outside diameter x root diameter x sheave width) $\Phi 916 \times \Phi 800 \times 110$ (mm), Sheave dimension $\Phi 916 \times \Phi 800 \times 125$ (mm) can be customized;
- The middle sheave can be customized as cast steel sheave.



Φ1040系列放线滑车 / Φ1040 Series Stringing Block

产品编号 Item No.	型号 Model	轮数 Sheave	额定负荷 (KN) Rated Load	重量 (KG) Weight	滑轮特征 Sheave Features
10165	SHDN1040	1	50	62	MC尼龙轮 MC nylon sheave
10166	SHSQN1040	3	100	200	中间: MC尼龙轮 导线: 压胶尼龙轮 Middle: MC nylon sheave Conductor: rubber lined MC nylon sheave
10167	SHWQN1040	5	200	330	



说明 / Explain

- 最大适用导线 LGJ1120;
- 滑轮尺寸Φ1040×Φ900×125 (mm);
- 可标准型为导线轮挂全胶, 需要半胶时合同注明。
- Maximum suitable conductor ACSR1120;
- Sheave dimension (outside diameter× root diameter × sheave width) Φ1040×Φ900×125(mm);
- The rubber lined MC nylon sheave are completely lined, half lined sheave can be customized.

Φ1160系列放线滑车 / Φ1160 Series Stringing Block

产品编号 Item No.	型号 Model	轮数 Sheave	额定负荷 (KN) Rated Load	重量 (KG) Weight	滑轮特征 Sheave Features
10168-1	SHD-1NJ-1000/60	1	60	65	MC尼龙轮 MC nylon sheave
10168-2	SHD-3NJ-1000/120	3	120	220	中间: MC尼龙轮 Middle: MC Nylon sheave 导线: 压胶尼龙轮 Conductor: MC Nylon with rubber liner

说明 / Explain

- 最大适用导线 LGJ1250;
- 导线滑轮尺寸Φ1160×Φ1000×150 (mm);
- 钢丝绳滑轮尺寸Φ1160×Φ1000×130(mm);
- 三轮加强型中间轮条用铸钢轮。
- Maximum suitable conductor ACSR1250;
- Sheave dimension for conductor (outside diameter× root diameter× sheave width) Φ1160×Φ1000×150(mm);
- Sheave dimension for steel wire rope (outside diameter× root diameter × sheave width) Φ1160×Φ1000×130(mm);
- Strengthening type three sheave , cast steel sheave for middle sheave.

单轮放线滑车 / Single Sheave Stringing Block

产品编号 Item No.	型号 Model	适用导线 Applicable Conductor ACSR	额定负荷 (KN) Rated Load	重量 (KG) Weight	备注 Remarks
10171	SHD-120×30	LGJ25~70	5	1.5	铝轮 Aluminum sheave
10172	SHD-160×40	LGJ95~120	10	2.5	
10173	SHD-200×40	LGJ150~240	15	4	
10174	SHD-200×60	LGJ150~240	15	4.6	
10175	SHD-250×40	LGJ150~240	20	4.6	
10176	SHD-250×60	LGJ300~400	20	6	
10177	SHD-270×60	LGJ300~400	20	7	
10178	SHD-320×60	LGJ300~400	20	9.5	
10179	SHD-400×80	LGJ400~500	20	15	
10191	SHND-120×30	LGJ25~70	5	1.5	尼龙轮 Nylon sheave
10192	SHND-160×40	LGJ95~120	10	2.5	
10193	SHND-200×40	LGJ150~240	15	3.6	
10194	SHND-200×60	LGJ150~240	15	4	
10195	SHND-250×40	LGJ150~240	20	4	
10196	SHND-250×60	LGJ300~400	20	4.5	
10197	SHND-270×60	LGJ300~400	20	5.6	
10198	SHND-320×60	LGJ300~400	20	6.7	
10199	SHND-400×80	LGJ400~500	20	13	

用途 / Uses

- 使用于在直线杆塔上展放导线, 压接管、钢丝绳和连接器等可以从槽内通过。
- Apply to pull conductor on straight pole. Splicing sleeve, steel wire rope and connector can pass through the groove.

说明 / Explain

- 本产品分吊钩式、挂板式、订货时要注明, 特殊规格可定制;
- 型号中数据表示该滑轮外径×轮宽(mm);
- Hanger includes hook type and plate type, plate type. This is need indicated when customer place order;
- The model represents the outer diameter and the sheave width of the stringing block.



■ 地线放线滑车 / Grounding Wire Stringing Block

产品编号 Item No.	型号 Model	滑轮规格(MM) Sheave Size	最大适用绞纹线 Applicable MAX Steel strand	额定负荷 Rated Load (KN)	重量 (KG) Weight	备注 Remarks
10331	SHT-120X30	Φ120X50	GJ35	5	2	钢轮 Steel Sheave
10332	SHT-150X32	Φ150X32	GJ70	10	3.5	
10333	SHT-165X50	Φ165X50	GJ120	20	4.5	
10334	SHT-200X60	Φ200X60	GJ150	20	5	
10341	SHT-120×30	Φ120×30	GJ35	5	1.6	尼龙轮 Nylon Sheave
10342	SHT-150×32	Φ150×32	GJ70	10	2.4	
10343	SHT-165×50	Φ165×50	GJ120	20	3.3	
10344	SHT-200X60	Φ200X60	GJ150	20	3.8	

用途 / Uses

- ◆ 用于延放钢绞线。
- ◆ Apply to pull steel strand.

■ 朝天放线滑车 / Swerve Skyward Stringing Block

产品编号 Item No.	型号 Model	适用导线(LGJ) Applicable Conductor ACSR	轮径×轮宽 Dia×Width	额定负荷 Rated Load (KN)	重量 (KG) Weight	备注 Remarks
10231	SHC-0.5	25-185	Φ80X50	5	1.7	铝轮 Aluminum Sheave
10232	SHC-2	35-240	Φ120X60	20	2.8	
10221	SHP-1	≤ 400		10	4.2	
10233	SHCN-0.5	25-185	Φ80X50	5	1.55	尼龙轮 Nylon Sheave
10234	SHCN-2	35-240	Φ120X60	20	2.5	
10222	SHCN-1	≤ 400		10	3.8	

用途 / Uses

- ◆ 适用于直线杆的角铁横担上延放中小截面的导线。
- ◆ Apply to pull small diameter conductor on the cross arm mounted of straight pole.



■ 朝天转角放线滑车 / Skyward Corner Stringing Block

产品编号 Item No.	型号 Model	适用导线 (LGJ) Applicable Conductor	额定负荷 (KN) Rated Load	重量 (KG) Weight	备注 Remarks
10281	SHCZ-0.5	25-185	5	2.1	铝轮 Aluminum Sheave
10282	SHCZ-0.5	25-185	5	1.8	尼龙轮 Nylon Sheave

用途 / Uses

- ◆ 本产品可固定在角钢横担转角处放线，分左向和右向两种。
- ◆ Product includes 2 types like left and right direction, It can be fixed on the pole arm for conductor pulling.



■ 坐挂两用放线滑车 / Sitting and hanging Type Dual-Use Stringing Block

产品编号 Item No.	型号 Model	额定负荷 Rated Load (KN)	滑轮规格 Sheave size(mm)	重量 (KG) Weight	备注 Remarks
10261	SHG-0.5	5	Φ80×50	2.1	铝轮 Aluminum Sheave
10263	SHG-1	10	Φ160×40	3.2	
10264	SHG-2	20	Φ120×58	3.6	
10271	SHGN-0.5	5	Φ80×50	1.95	尼龙轮 Nylon Sheave
10273	SHGN-1	10	Φ160×40	2.6	
10274	SHGN-2	20	Φ120×58	3.4	

用途 / Uses

- ◆ 既可作悬挂型放线滑车又可作朝天放线滑车。
- ◆ Product can be used either hanging type stringing block or skyward stringing block.



■ 朝天3用放线滑车 / Skyward Three Purpose Stringing Block

产品编号 Item No.	型号 Model	适用导线(LGJ) Applicable Conductor	额定负荷 (KN) Rated Load	重量 (KG) Weight	备注 Remarks
10291	SHCS-2	≤ 240	20	4.7	铝轮 Aluminum Sheave
10292	SHCS-2	≤ 240	20	4.1	尼龙轮 Nylon Sheave

用途 / Uses

- ◆ 可直、左、右三个方向使用，用在直线或左转弯的转角杆放线。
- ◆ It can be used in three direction: Straight, left and right.



■ 双轮放线滑车 / Tandem Sheave Stringing Block

产品编号 Item No.	型号 Model	适用导线(LGJ) Applicable Conductor	额定负荷 (KN) Rated Load	重量 (KG) Weight	备注 Remarks
10211	SHR-2.5	LGJ300-500	25	11	铝轮 Aluminum Sheave
10212	SHRN-2.5	LGJ300-500	25	9.5	尼龙轮 Nylon Sheave

用途 / Uses

- ◆ 适用于引放截面导线，压接管可从轮槽中通过。
- ◆ Apply to leading and pull large section conductor, Splicing sleeve can pass through from the groove.

■ 架空放线滑车/Aerial Cable Stringing block

产品编号 Item No.	滑轮尺寸(mm) Sheave size	最大电缆 Max Applicable Cable	额定负荷 (KN) Rated Load	重量 (KG) Weight
10228	Φ120X130	Φ100	5	2.7
21338	Φ160X90	Φ80	5	3.5
21339	Φ140X160	Φ150	5	3.5
21340	Φ160X230	Φ200	5	12.5

用途 / Uses

- ◆ 10228用于ABC电缆(集束导线)敷线。
- ◆ 21338、21339和21340用于电缆架空放线。
- ◆ 10228 Suitable for ABC cable(bunch).
- ◆ 21338、21339 and 21340 Suitable for aerial electric power and communication cable construction.

■ 光缆滑车 / OPGW Cable Stringing Block

产品编号 Item No.	滑轮尺寸(mm) Sheave size	额定负荷 (KN) Rated Load	重量 (KG) Weight	型式 Model
20131	Φ660X110	20	27	直线通过型 Straight through

用途 / Uses

- ◆ 用于展放各种光缆。
- ◆ Apply to pull OPGW/ADSS.

特点 / Feature

- ◆ 采用Φ660尼龙滑轮，槽底有光缆小槽。
- ◆ Put to use Φ660mm nylon sheave. The small optical cable groove under the groove



10228 21339 21340 21338

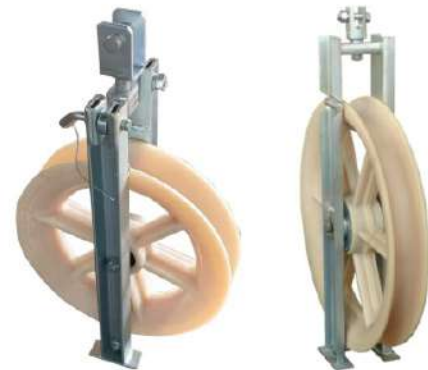

■ 钢轮起重滑车 / Hoisting Tackle(Casting steel sheave)

产品编号 Item No.	型号 Model	滑轮数 sheave	额定负荷 (KN) Rated Load	外径×轮宽(MM) Roller Dia×width	最大绳径 (mm) MAX. Rope Diameter	重量 (KG) Weight
11181	QH1X1	1	10	Φ100×31	Φ7.7	3.0
11182	QH1X2	2		Φ80×27	Φ5.7	3.0
11183	QH1X3	3		Φ80×27	Φ5.7	4.3
11191	QH2X1	1	20	Φ120×35	Φ11	4.7
11192	QH2X2	2		Φ100×31	Φ7.7	5.3
11193	QH2X3	3		Φ100×31	Φ7.7	7.2
11201	QH3X1	1	30	Φ150×39	Φ12.5	6.5
11202	QH3X2	2		Φ120×35	Φ11	7.8
11203	QH3X3	3		Φ100×31	Φ7.7	10.5
11211	QH5X1	1	50	Φ166×40	Φ15.5	9.0
11212	QH5X2	2		Φ150×39	Φ12.5	10.8
11213	QH5X3	3		Φ120×35	Φ11	13.8
11221	QH8X1	1	80	Φ205×50	Φ18.5	14.4
11222	QH8X2	2		Φ166×40	Φ15.5	19.0
11223	QH8X3	3		Φ150×39	Φ12.5	19.8
11231	QH10X1	1	100	Φ246×60	Φ20	21.0
11232	QH10X2	2		Φ166×40	Φ18.5	24.0
11233	QH10X3	3		Φ150×39	Φ15.5	24.8
11241	QH15-1	1	150	Φ280×64	Φ21.5	41.0
11242	QH15-2	2		Φ205×50	Φ18.5	33.0
11243	QH15-3	3		Φ166×40	Φ15.5	26.0
11244	QH15-4	4	200	Φ150×39	Φ12.5	28.0
11248	QH20-4	4		Φ205×50	Φ18.5	50.0



用途 / Uses

- ◆ 用于组立杆塔、架线、吊装设备及其它起重作业。
- ◆ Apply to assemble and erect the tower, line construction hoist devices and other hoist operation.

说明 / Explain

- ◆ 订货时应注明需要钩式、环式或吊板式。
- ◆ Hanger includes hook type, plate type and ring type. This is need indicated when customer place order.

■ 尼龙轮起重滑车 / Hoisting Tackle (Aluminum Alloy Plate With Nylon Sheave)

产品编号 Item No.	型号 Model	滑轮数 Sheave	额定负荷 Rated Load (KN)	外径×轮宽(MM) Roller Dia×width	最大绳径 (mm) MAX. Rope Diamete	重量 (KG) Weight
11101	QHN1X1	1	10	Φ100×31	Φ7.7	1.8
11102	QHN1X2	2		Φ80×27	Φ5.7	1.8
11103	QHN1X3	3		Φ80×27	Φ5.7	2.1
11111	QHN2X1	1	20	Φ120×35	Φ11	2.9
11112	QHN2X2	2		Φ100×31	Φ7.7	3.1
11113	QHN2X3	3		Φ100×31	Φ7.7	3.8
11121	QHN3X1	1	30	Φ150×39	Φ12.5	4.1
11122	QHN3X2	2		Φ120×35	Φ11	4.3
11123	QHN3X3	3		Φ100×31	Φ7.7	5.3
11131	QHN5X1	1	50	Φ166×40	Φ15.5	5.6
11132	QHN5X2	2		Φ150×39	Φ12.5	6.1
11133	QHN5X3	3		Φ120×35	Φ11	7.3
11141	QHN8X1	1	80	Φ205×49	Φ18.5	8.8
11142	QHN8X2	2		Φ166×40	Φ15.5	8.6
11143	QHN8X3	3		Φ150×39	Φ12.5	9.6
11151	QHN10X1	1	100	Φ246×60	Φ20	12.1
11152	QHN10X2	2		Φ166×40	Φ18.5	11.8
11153	QHN10X3	3		Φ150×39	Φ15.5	13.2

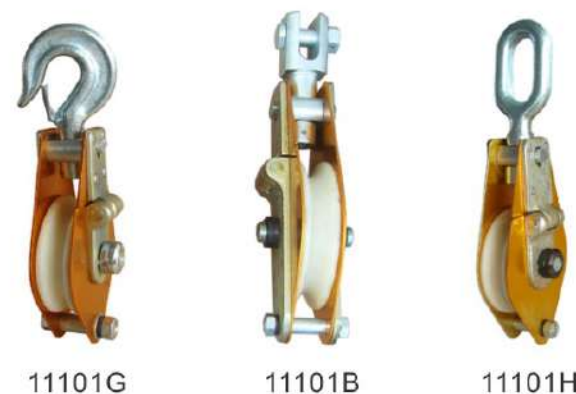

说明 / Explain

- 订货时注明需要开口、闭口、钩式、环式。
- Accessories style is need to indicated such like open type, close type, hook type and ring type when customer place order.

用途 / Uses

- 适用于电力线路施工中组立杆塔、架线、吊装设备及其它起重作业。
- Apply to assemble and erect the tower, line construction, hoist devices and other hoist operation.

特点 / Feature

- 采用铝合金侧板, MC尼龙滑轮, 自重较轻。
- Product is made of aluminum alloy plate with MC nylon wheel, it has light weight.

■ 双面开口起重滑车 / Hoisting Tackle (Both Side Opening With Dual-Sheave)

产品编号 Item No.	型号 Model	额定负荷 (KN) Rated Load	绳径 Rope Diameter	重量 (KG) Weight
11281	QHS2-3	30	≤ Φ11	6.3
11282	QHS2-5	50	≤ Φ12.5	11.0
11283	QHS2-8	80	≤ Φ15.5	16.0
11284	QHS2-10	100	≤ Φ18.5	18.0

特点 / Feature

- 滑车两侧均可开口, 装卸钢丝绳方便。
- Loading and unloading steel wire rope conveniently with double side opening.

说明 / Explain

- 订货时应注明需要钩式 (G) 或环式 (H)。
- Hook or ring type is need indicated when customer place order.



■ 铝轮起重滑车 / Hoisting Tackle (Aluminum Sheave)

产品编号 Item No.	型号 Model	滑轮数 Sheave	额定负荷 (KN) Rated Load	最大绳径 (mm) MAX. Rope Diameter	重量 (KG) Weight
11301	QHL1X1	1	10	Φ7.7	1.8
11302	QHL1X2	2		Φ5.7	1.8
11303	QHL1X3	3		Φ5.7	2.1
11311	QHL2X1	1	20	Φ11	2.9
11312	QHL2X2	2		Φ7.7	3.1
11313	QHL2X3	3		Φ7.7	3.8
11321	QHL3X1	1	30	Φ12.5	4.1
11322	QHL3X2	2		Φ11	4.3
11323	QHL3X3	3		Φ7.7	5.3
11331	QHL5X1	1	50	Φ15.5	5.6
11332	QHL5X2	2		Φ12.5	6.1
11333	QHL5X3	3		Φ11	7.3
11341	QHL8X1	1	80	Φ18.5	8.8
11342	QHL8X2	2		Φ15.5	8.6
11343	QHL8X3	3		Φ12.5	9.6
11351	QHL10X1	1	100	Φ20	12.1
11352	QHL10X2	2		Φ18.5	11.8
11353	QHL10X3	3		Φ15.5	13.2



用途 / Uses

- 适用于电力线路施工中组立杆塔、架线、吊装设备及其它起重作业。
- Apply to assemble and erect the tower, line construction, hoist devices and other hoist operation.

特点 / Feature

- 采用铝合金侧板，铝合金滑轮，自重较轻。
- Product is made of aluminum alloy plate with aluminum alloy Sheave, it has light weight.

说明 / Explain

- 订货时注明需要开口、闭口、钩式、环式。
- Accessories style is need to indicated such like open type, close type, hook type and ring type when

■ 绝缘起重滑车 / Insulated Hoisting Tackle (Epoxy Resin Plate With Nylon Sheave)

产品编号 Item No.	型号 Model	滑轮数 Sheave	额定负荷 (KN) Rated Load	最大绳径 (mm) MAX. Rope Diameter	重量 (KG) Weight
11401	QHJ1X1	1	10	Φ7.7	1.8
11402	QHJ1X2	2		Φ5.7	1.8
11403	QHJ1X3	3		Φ5.7	2.1
11411	QHJ2X1	1	20	Φ11	2.9
11412	QHJ2X2	2		Φ7.7	3.1
11413	QHJ2X3	3		Φ7.7	3.8
11421	QHJ3X1	1	30	Φ12.5	4.1
11422	QHJ3X2	2		Φ11	4.3
11423	QHJ3X3	3		Φ7.7	5.3
11424	QHJ3X4	4	50	Φ7.7	6.3
11431	QHJ5X1	1		Φ15.5	5.6
11432	QHJ5X2	2		Φ12.5	6.1
11433	QHJ5X3	3	50	Φ11	7.3
11434	QHJ5X4	4		Φ11	8.3
11441	QHJX1	1		5	Φ7.7
11442	QHJX2	2	Φ5.7		1.3
11443	QHJX3	3	Φ5.7		1.8



用途 / Uses

- 适用于电力线路施工中组立杆塔、架线、吊装设备及其它起重作业。
- Apply to assemble and erect the tower, line construction, hoist devices and other hoist operation.

特点 / Feature

- 采用环氧树脂侧板，MC尼龙滑轮，自重较轻。
- Product is made of Epoxy Resin plate with MC nylon sheave, it has light weight.

说明 / Explain

- 订货时注明需要开口、闭口、钩式、环式。
- Accessories style is need to indicated such like open type, close type, hook type and ring type when customer place order.

■ 地面直线滑车 / Cable ground roller

产品编号 Item No.	型号 Model	适用电缆直径 (MM) Applicable Cable Diameter	额定负荷 (KN) Rated Load	结构形式 Carrier Structure	重量 (KG) Weight	
21171	SHL1	≤ Φ150	5	铸铝架 Casting Aluminum Carrier	5.4	
21172	SHL1N		5		3.6	
21181	SHL1B	≤ Φ150	5	钢板架 Steel Plate Carrier	5.5	
21182	SHL1BN		5		3.7	
21183	SHL2BN		≤ Φ160		5	5.5
21184	SHL3BN	≤ Φ200	5		8.0	
21191	SHL1G	≤ Φ150	5	钢管架 Steel Pipe Carrier	5.1	
21192	SHL1GN		5		3.3	
21193	SHL2GN		≤ Φ160		5	6.5
21194	SHL3GN		≤ Φ200		5	8.5



说明 / Explain

- ◆ 用于直径Φ200以下电缆, 型号中带N为尼龙轮, 不带N为铝轮。
- ◆ Apply to cable diameter is less than 200mm, Nylon sheaves are represented by N letters. The rest are aluminum sheaves.

■ 地面转角滑车 (三轮组) / Corner Ground Roller (Tri-sheave)

产品编号 Item No.	型号 Model	适用电缆直径 (MM) Applicable Cable Diameter	额定负荷 (KN) Rated Load	重量 (KG) Weight
21223	SHL3	≤ Φ120	10	11
21224	SHL3N		10	9
21221	SHL2	≤ Φ150	10	12
21222	SHL2N		10	10
21224A	SHL4N	≤ Φ200	10	25



用途 / Uses

- ◆ 适用于大直径电缆通过。
- ◆ Apply to large diameter cable pass through.

说明 / Explain

- ◆ 可根据需要多台组合成任意转弯角度。型号中带N为尼龙轮, 不带N为铝轮。
- ◆ They can be built up arbitrary turning angle on requirements. Nylon sheaves are represented by N letters. The rest are aluminum.

■ B系列孔口滑车 / B Series Cable Entrance Protection Roller

产品编号 Item No.	型号 Model	管孔直径 (MM) Tube Diameter	重量 (KG) Weight
21241	SH80B	80	3.3
21242	SH90B	90	3.5
21243	SH100B	100	3.8
21244	SH130B	130	6.0
21245	SH150B	150	7.2
21245A	SH180B	180	10
21246	SH200B	200	12



用途 / Uses

- ◆ 用于电缆展放。
- ◆ Apply to cable extension.

特点 / Feature

- ◆ 单轮, 滑轮可按牵引需要以任意角度放置于孔口, 并可锁紧, 尼龙轮, 钢件表面镀锌。
- ◆ The roller can be placed in tube entrance at arbitrary angle and lockable zinc-coated steel surface with single nylon sheave.

■ D系列孔口滑车 / D Series Cable Entrance Protection Roller

产品编号 Item No.	型号 Model	管孔直径 (MM) Tube Diameter	重量 (KG) Weight
21271	SH80DA	80	4.3
21272	SH90DA	90	4.6
21273	SH100DA	100	5.0
21274	SH130DA	130	6.9
21275	SH150DA	150	9.0
21275A	SH180DA	180	11.0
21276	SH200DA	200	12.8



用途 / Uses

- ◆ 用于电缆展放。
- ◆ Apply to cable extension.

特点 / Feature

- ◆ 单轮, 加长固定式定位机构, 尼龙轮。
- ◆ Enhanced length fixed mechanism with single nylon sheave.

■ C系列孔口滑车 / C Series Cable Entrance Protection Roller

产品编号 Item No.	型号 Model	管孔直径 (MM) Tube Diameter	重量 (KG) Weight
21251	SHL80C	80	17.0
21252	SHL90C	90	18.0
21253	SHL100C	100	20.0
21254	SHL130C	130	20.5
21255	SHL150C	150	21.0
21255A	SHL180C	180	22.0
21256	SHL200C	200	23.0
21261	SHL80C1	80	24.0
21262	SHL90C1	90	25.0
21263	SHL100C1	100	25.0
21264	SHL130C	130	25.0
21265	SHL150C1	150	26.0
21265A	SHL180C1	180	27.0
21266	SHL200C1	200	30.5

21251



21261



说明 / Explain

- ◆ 三轮，曲率半径450mm，四轮，弯曲半径1000mm，滑轮可按牵引需要以任何角度旋转于孔口，并可锁紧，尼龙轮，钢件表面镀锌。
- ◆ 3 Sheaves curvature radius is 450mm.4 sheaves curvature radius is 1000mm.The roller can be placed in tube orifice at arbitrary angle and lockable with zinc-coated steel surface and nylon sheaves.

■ 井口滑车 / Cable Pithead Roller

产品编号 Item No.	型号 Model	额定负荷 (KN) Rated Load	适用电缆直径(MM) Applicable Cable Diameter	重量 (KG) Weight
21303	SH130S	10	≤ Φ130	12
21304	SH200S	10	≤ Φ200	13
21283	SHH1L	10	≤ Φ80	7.2
21282	SHH1N	10	≤ Φ80	6.2
21282X	SHH3N	10	≤ Φ80	6.2
21285	SHL450J	10	≤ Φ100	9
21286	SHL700J3	10	≤ Φ160	14
21287	SHL700J6	20	≤ Φ160	23

用途 / Uses

- ◆ 井口电缆滑车用于电缆井口处电缆和牵引绳的保护。
- ◆ Pithead cable roller is apply to protecting cable and pulling rope on the pithead.

21303/21304



21283



21282X

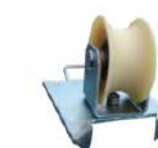

21282



21285



21287

■ 孔口/井口保护弯板 / Cable Protective Bend Board

产品编号 Item No.	型号 Model	管孔直径 (MM) Tube Diameter	弯曲半径 (MM) Curvature diameter	重量 (KG) Weight
21321	GKB100A	Φ100	R400	3.2
21322	GKB130A	Φ130	R450	5.2
21322A	GKB150A	Φ150	R450	5.9
21325	GKB100B	Φ100	R450	3.4
21326	GKB130B	Φ130	R450	6

产品编号 Item No.	型号 Model	最大电缆直径 (mm) Max. Cable Diameter	弯曲半径 (MM) Curvature diameter	重量 (KG) Weight
21305	JKD80	Φ80	R400	5
21307	JKD100	Φ100	R400	5.2
21306	JKD130	Φ130	R500	6
21308	JKD150	Φ150	R500	6.5

说明 / Explain

- ♦ 用于管口或井口处电缆和牵引绳的保护。弧面45°或60°包角
- ♦ Protect cable and pulling rope at pipe mouth pithead. Cambered surface 45° or 60° wrap angle.

■ 电缆转向滑车 / Cable Turning Roller

产品编号 Item No.	型号 Model	额定负荷 (KN) Rated Load	结构形式 Structure
21231	SHZL1	10	单向 One way
21232	SHZL1N	10	单向 One way
21233	SHZL1T	10	双向 Two way
21234	SHZL1TN	10	双向 Two way

用途 / Uses

- ♦ 用于小截面电缆弯弧度不大处，型号中带N为尼龙轮其余为铝轮。
- ♦ Apply to small turning radius of small section cable. Nylon sheaves are represented by N letters. The rest are aluminum sheaves.

21321



21325

21305



21231

21234

21232



■ 电缆框式滑车 / Framed Cable Roller

产品编号 Item No.	型号 Model	最大电缆直径 (MM) Max. Cable Diameter	额定负荷 (KN) Rated Load	托辊直径 (MM) Carrier roller dia	托辊数量(只) Number Of Carrier Roller	重量 (KG) Weight
21229	SHD4K180	Φ180	20	Φ60	4	16
21229L	SHD4K180L	Φ180	20	Φ60	4	16
21228	SHD6K180	Φ180	20	Φ60	6	16
21228L	SHD6K180L	Φ180	20	Φ60	6	20

用途 / Uses

- ♦ 用于大直径电力电缆敷设施工，地面、架桥等场合。
- ♦ For large diameter power cable installation.

特点 / Feature

- ♦ 采用铝合金或尼龙轮的托辊；防尘滚动轴承；钢架结构油漆防腐；可通过地脚孔与地面或桥架等固定。
- ♦ Adopt aluminium alloy strengthening carrier roller Dustproof bearing Painted steel framed structure Can be fixed on the ground or cable tray

21229



21229L



■ 托线电缆滑车 / Hold-On Roller

产品编号 Item No.	型号 Model	长度 (m) Length	重量 (KG) Weight	特征 Feature
21291	SHC1000	1	27.3	V型折叠
21292	SHC1500	1.5	30.5	V型折叠
21293	SHC2000	2	35.5	V型折叠
21294	Dr1	1	14	直线型

说明 / Explain

- ♦ 用于电缆盘出来部位，避免电缆拖地；钢质托轮。
- ♦ Avoid cable to touch the ground Steel Roller.

21294



21291

压线滑车 / Hold Down Wire Block

产品编号 Item No.	型号 Model	适用范围 Applicable Conductor	额定负荷 (KN) Rated Load	重量 (KG) Weight	备注 Remarks
10241	SHY10L	≤ LGJ400	10	13	铝轮包胶 Aluminum Sheave With Rubber Liner
10242	SHY10G	≤ LGJ120	10	20	钢轮 Steel Sheave
10243	SHY25N	≤ LGJ720	25	16	MC尼龙轮 MC Nylon Sheave
10244A	SHY40G	≤ Φ28	40	55	钢轮 Steel Sheave
10244B	SHY40L	≤ LGJ720	40	39	铝轮 Aluminum Sheave
10244C	SHY40N	≤ LGJ720	40	34	MC尼龙轮 MC Nylon Sheave



用途 / Uses

- 适用于放线过程中压住上扬的导、地线。
- Apply to hold down the the upward conductor and ground wire in pulling.

接地滑车 / Grounding Block

产品编号 Item No.	型号 Model	滑轮底径 (MM) Bottom Diameter	适用线型 Applicable Wire	最大电流 (A) Max Current	滑轮材料 Sheave Material	重量 (KG) Weight
12101	SJL-100	Φ50	导线 Φ40 Conductor	100	铸铝 Casting steel	8.9
12102	SJT-100	Φ50	地线 Φ40 Grounding Wire	100	铸铁 Casting steel	10.0

用途 / Uses

- 用于张力架线消除被放导线或地线上产生的静电感应。
- Apply to eliminating induced static/electricity in conductor or grounding wire spread when tension stringing.

说明 / Explain

- 接地线和接地桩另配，推荐配套接地线25mm²。
- Grounding wire and grounding pile provide additionally. Section of matching grounding wire is recommended as 25mm².

钩式接地滑车 / Hook Type Grounding Block

产品编号 Item No.	型号 Model	滑轮底径 (MM) Bottom Diameter	适用范围 Applicable Conductor	滑轮材料 Sheave Material	重量 (KG) Weight
12111	SHL750D	Φ75	导线 Φ6-Φ38 Conductor	铝合金 Aluminum Alloy	4.5
12112	SHG60D	Φ60	钢丝绳和钢绞线 Φ6-Φ28 Steel Wire Rope And Steel strand	钢 Steel	5.0

用途 / Uses

- 用于放线作业时消除导、地线上的感应电。
- Apply to eliminating the faradism in conductor and grounding wire.

说明 / Explain

- 使用时安装在张力机的出线侧和牵引机的进线侧，并用两根拉线拉住；三轮结构，扭簧自动压紧；允许最大电流100A，通过时间0.1秒；
- It is mounted on the outlet side of tensioner and inlet side of puller, and held by two stay wires; Tree Sheave mechanism compacted automatically by torsional spring; Maximum allowable current is 100A, time electrified is 0.1 second;



高速转向滑车 / High Speed Turning Block

产品编号 Item No.	型号 Model	额定负荷 (KN) Rated Load	滑轮外径 Sheave Diameter	轮宽 Sheave width	重量 (KG) Weight	备注 Remark
12141	THZ1-5	50	Φ308	75	22	钢轮 Steel Sheave
12142	THZ1-16	160	Φ600	92	115	
12143	THZ1-30	300	Φ916	110	200	

用途 / Uses

- 用于张力架线时牵引钢丝绳转向，可通过钢丝绳连接器；允许牵引绳最大速度≥80m/min。
- Apply to steel wire rope traction and turning. It can pass through steel wire rope connector; The maximum allowable speed of hauling rope is 80m/min.



吊点滑车 / Hoisting Point Block

产品编号 Item No.	型号 Model	额定负荷 (KN) Rated Load	滑轮外径 (MM) Sheave Diameter	滑轮宽 (MM) Sheave width	重量 (KG) Weight
12130	QHD-30	30	126	32	5
12131	QHD-50	50	160	36	8
12132	QHD-80	80	190	42	12
12133	QHD-160	160	270	58	23



用途 / Uses

- 在倒落式人字抱杆多点组立杆塔时于吊点相连；代替起重滑车。
- Fixing with hoist point on the A shape lattice structure holding Pole; in order to instead of hoisting tackle.

说明 / Explain

- 质量轻，使用方便，承载能力强。
- It is easy to use with light weight and strong carrying capacity.

双轮换线滑车 / Double sheave block for changing line

产品编号 Item No.	型号 Model	外形尺寸 (MM) Outline Size	额定负荷 (KN) Rated Load	重量 (KG) Weight
20123	SH2-OPGW1	152X110X343	2	2.4
20124	SH2-OPGW2	128X65X365	2	2.2

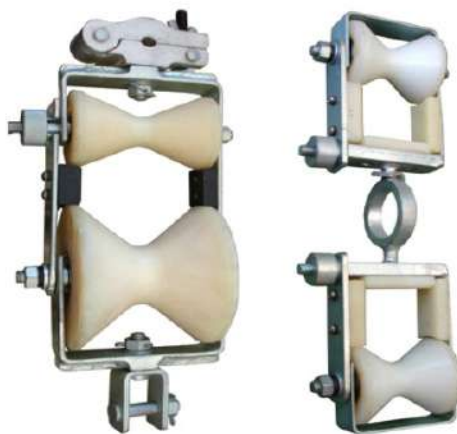

用途 / Uses

- 用于架空地线更换成OPGW作业。
- Suitable for exchanging overhead grounding wire with OPGW operation.

尽头滑车 / Ending Block

产品编号 Item No.	型号 Model	额定负荷 (KN) Rated Load	滑轮外径 (MM) Sheave Diameter	滑轮宽 (MM) Sheave width	重量 (KG) Weight
12191	SH30J	30	Φ140	36	5.3
12192	SH50J	50	Φ160	48	9.0
12193	SH80J	80	Φ180	56	16.5



用途 / Uses

- 用于紧线。
- Apply to tighten up conductor wire.

特点 / Feature

- 侧板可打开，方便施工。
- Side plate can open and it is convenient for line construction.

组合式光缆滑车 / Combination Optical Cable Slewing Car

产品编号 Item No.	型号 Model	外形尺寸 (MM) Outline Size	额定负荷 (KN) Rated Load	弯曲半径 Bend Radius	重量 (KG) Weight
20141	SHZHD10	760X120X480	10	R570	23.5

用途 / Uses

- 用于展放Φ22mm以下的光缆或Φ60mm以下的电缆。
- To string the optical cables below Φ22mm or the cables below Φ60mm.

特点 / Feature

- 采用四轮组合结构，曲率半径大。
- Adopts four sheaves structure, bend radius.

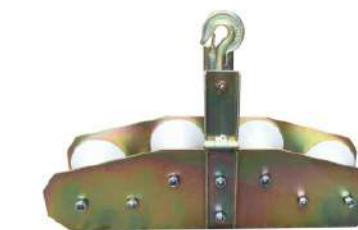

带接地轮放线滑车 / Grounding Roller Stringing Block

产品编号 Item No.	型号 Model	滑轮尺寸 (MM) Outside Diameter Of Sheave	滑轮数 Sheaves	产品编号 Item No.	型号 Model	滑轮尺寸 (MM) Outside Diameter Of Sheave	滑轮数 Sheaves
10301	SHDN508D	Φ508×75 (508*100)	1	10316-1	SHDN822D	Φ822×110	1
10302	SHSN508D		3	10316-3	SHSN822D		3
10303	SHWN508D		5	10316-5	SHWN660D		5
10311	SHDN660D	Φ660×100 (660×110)	1	10316	SHDN916D	Φ916×110	1
10312	SHSN660D		3	10317	SHSN916D		3
10313	SHWN660D		5	10318	SHWN916D		5



用途 / Uses

- 用于放线施工时释放线路上的感应电流。
- Apply to release the induced current on the line for stringing construction.

三联放线滑车 / Three Sheaves Stringing Block

产品编号 Item No.	型号 Model	额定负荷 (KN) Rated Load	重量 (KG) Weight	备注 Remark
10226	SH80S	5	2.8	尼龙轮 Nylon Sheave



用途 / Uses

- 适用于一牵三展放小截面导线。
- Apply to one pull three bundle small bore conductor.

铝合金导线卡线器 / Aluminum Alloy Conductor Gripper

产品编号 Item No.	型号 Model	额定负荷 (KN) Rated Load	适用导线 Applicable Conductor	最大开口 (MM) Max. Open	重量 (KG) Weight
13221	SKL-7	7	LGJ25-70	14	1.0
13222	SKL-15	15	LGJ95-120	18	1.4
13223	SKL-25	25	LGJ150-240	24	3.0
13224	SKL-40	40	LGJ300-400	32	4.0
13225A	SKL-50C	50	LGJ500-630	36	6.6
13224A	SKL-40A	40	LGJ400	32	4.3
13225	SKL-50A	50	LGJ500	34	7.0
13226	SKL-50B	50	LGJ630	36	7.3
13227	SKL-60	60	LGJ720	38	9.2
13228	SKL-70	70	LGJ900	42	14.0
13229	SKL-80	80	LGJ1000	45	18.0
13229A	SKL-80A	80	LGJ1120	48	18.0



用途 / Uses

- 适用于架线时调整弧垂、拉紧导线。
- Apply to adjusting the sag and tensioning the conductor wire in power lines construction.

特点 / Feature

- 采用高强度铝合金材料，锻制成型，具有强度高、体积小、重量轻。
- Product is forged of high strength aluminum alloy with small size and light weight.

■ 铝合金绝缘导线卡线器 / Aluminum Alloy Insulated Conductor Gripper

产品编号 Item No.	型号 Model	额定负荷 (KN) Rated Load	适用导线 (LGJ) Applicable Conductor	适用线材直径 (MM) Applicable Wire Diameter	最大开口 (MM) Max. Open	重量 (KG) Weight
13192	SKJL-1	10	25-70	Φ10-Φ14	15	1.4
13202	SKJL-1.5	15	95-120	Φ14-Φ20	22	3.0
13212	SKJL-2	20	150-240	Φ20-Φ25	27	4.0
13213	SKJL-2.5	25	300-400	Φ25-Φ32	34	4.0
13214	SKJLA-3	30	500-630	Φ32-Φ37	39	4.0

用途 / Uses

- ◆ 卡紧绝缘导线，调整弧垂，拉紧导线且固定。
- ◆ Product is clamping, fixing and adjusting the sag of insulated conductor.

特点 / Feature

- ◆ 采用高强度铝合金材料，自重轻不损绝缘层。
- ◆ Product is made of high strength aluminum alloy with light weight, It will not damage the insulation layer.



■ 防扭钢丝绳卡线器 / Anti Twist Steel Rope Gripper

产品编号 Item No.	型号 Model	额定负荷 (KN) Rated Load	适用防扭钢丝绳 Applicable Anti Twist Steel Rope	重量 (KG) Weight
13155	SKG50N	50	□ 11-15	7.0
13156	SKG70N	70	□ 16-18	8.0
13157	SKG120N	120	□ 19-21 或 □ 22-24	11.6
13158	SKG200N	200	□ 26-28 或 □ 30	23.5

用途 / Uses

- ◆ 适用于编织防扭钢丝绳。
- ◆ Apply to grip anti-twisting steel rope.

说明 / Explain

- ◆ 订货时应注明防扭钢丝绳的详细规格。

特点 / Feature

- ◆ 单V型钳口，两侧板对称受力，有效减轻了重量。
- ◆ Single "V" type grip, with symmetrical loading.

- ◆ Anti-twisting steel rope specification is need indicated when customer place order.



■ 双桃卡线器 / Dual Cam Earth Wire Gripper

产品编号 Item No.	型号 Model	适用钢绞线 Applicable Steel Strand	额定负荷(KN) Rated Load	适用线材直径 Applicable Wire Diameter	重量 (KG) Weight
13141	SKDS-1	GJ25-50	10	11	2.6
13142	SKDS-2	GJ50-70	20	13	3.1
13143	SKDS-3	GJ70-120	30	15	4.1

用途 / Uses

- ◆ 适用于拉线杆塔的拉线调整和地线紧线。
- ◆ It is suitable for the steel strand adjustment of the guyed tower and the ground wire tightening.

■ 万能卡线器 / Universal Gripper

产品编号 Item No.	型号 Model	额定负荷(KN) Rated Load	适用线材直径 Applicable Wire Diameter	重量 (KG) Weight
13310	1000	10	2.5-16	1.3
13311	2000	20	4-22	1.6
13312	3000	30	16-32	2.8

特点 / Feature

- ◆ 合金钢材质锻造，并经热处理，品质优良。齿条抗张力强，咬合度高，不易滑落与变形。
- ◆ Product is forged of alloy steel with heat treatment. The rack has strong anti-tension with high occlusion strength. It is not easy to slide and deformation.

■ 平行卡线器 / Parallel Earth Wire Gripper

产品编号 Item No.	型号 Model	适用钢绞线 Applicable Steel Strand	额定负荷 (KN) Rated Load	最大开口(MM) Max Open	重量 (KG) Weight
13121	SKDP-1	GJ16-70	10	13	1.2
13122	SKDP-2	GJ50-150	20	18	2
13123	SKDP-3	GJ150-300	30	26	3.8

用途 / Uses

- ◆ 适用于拉线杆塔的拉线调整和地线紧线。
- ◆ It is suitable for the steel strand adjustment of the guyed tower and the ground wire tightening.

特点 / Feature

- ◆ 钳口防滑处理好，具有预紧性。
- ◆ The clamp adopts antiskid processing, With pre tightening force.



■ 光缆卡线器 / Optical Cable Wire Gripper

产品编号 Item No.	光缆直径(MM) Cable Diameter	额定负荷 (KN) Rated Load	重量 (KG) Weight
20101	Φ8-20	25	3.8
20102	Φ20	45	3.8
20103	Φ11-15	16	5.6
20104	Φ15-17	16	5.6

用途 / Uses

- ◆ 用于OPGW施工。
- ◆ Apply to OPGW construction.

特点 / Feature

- ◆ 铝合金主体材料，有效保护OPGW。
- ◆ The main body is made of aluminum alloy and it can protect the OPGW effectively.

说明 / Explain

- ◆ 20101产品订货时注明OPGW直径。
- ◆ OPGW diameter is need to indicated when customer place order item" 20101" .

20103/20104



20101/20102



■ 高强度卸扣 / High Strength Shackle

产品编号 Item No.	型号 Model	额定负荷 (KN) Rated Load	主要尺寸 (MM) Main Size				重量 (KG) Weight
			A	B	C	D	
17131	GXK-1	10	57	78	12	20	0.15
17132	GXK-2	20	65	95	16	22	0.29
17133	GXK-3	30	80	120	20	34	0.80
17133A	GXK-3A	30	80	150	20	34	0.80
17134	GXK-5	50	100	135	22	39	1.12
17134A	GXK-5A	50	100	177	22	39	1.12
17135	GXK-8	80	118	152	25	48	2.40
17136	SLK-10	100	133	173	30	49	3.56
17137	SLK-16	160	155	220	37	56	4.80
17138	SLK-20	200	164	240	39	60	5.17
17139	SLK-30	300	186	270	50	68	7.5

用途 / Uses

- ◆ 连接钢丝绳及物件装卸。
- ◆ Connecting steel rope with loading operation.

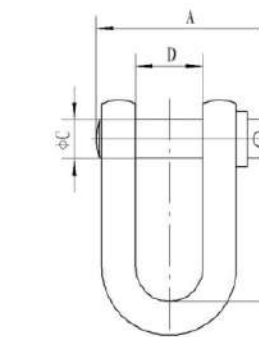

■ 抗弯连接器 / Fixed Joints

产品编号 Item No.	型号 Model	额定负荷 (KN) Rated Load	主要尺寸 (MM) Main Size							重量 (KG) Weight
			A	B	C	D	E	F	d	
17111	SLU-1	10	36	68	18	10	14	29	10	0.2
17112	SLU-3	30	37	76	20	12	17	31	12	0.22
17113	SLU-5	50	50	96	23	18	19	42	18	0.6
17114	SLU-8	80	56	110	28	20	22	50	20	0.8
17115	SLU-10	100	59	126	30	22	26	54	22	1.2
17116	SLU-13	130	61	134	32	24	27	56	24	1.3
17117	SLU-15	150	63	138	37	27	28	58	27	1.4
17118	SLU-25	250	80	178	44	32	35	72	30	3.0

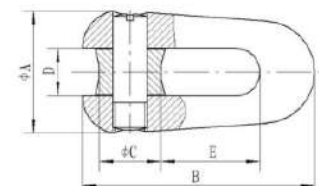

用途 / Uses

- ◆ 适用于导线，钢芯铝绞线放线时连接牵引钢丝绳。
- ◆ Apply to connecting pilot rope or pulling rope and to pass over the puller or tensioner bull wheels.

特点 / Feature

- ◆ 采用优质钢材，强度高，体积小，能通过放线滑车。
- ◆ Made of high quality steel with high strength and small size. It can pass over stringing block.

说明 / Explain

- ◆ d为销子直径。
- ◆ Number "d" means the pin diameter.

■ 旋转连接器 / Swivel Joint

产品编号 Item No.	型号 Model	额定负荷 (KN) Rated Load	主要尺寸 (MM) Main Size					重量 (KG) Weight
			A	B	C	D	E	
17121	SLX-0.5	5	19	61	40	8	9	0.20
17122	SLX-1	10	30	100	70	12	13	0.40
17123	SLX-2	20	35	120	90	14	14	0.55
17124	SLX-3	30	37	129	95	16	16	0.65
17125	SLX-5	50	42	154	116	18	17	1.50
17126	SLX-8	80	57	220	165	24	22	2.40
17127	SL130	130	62	248	192	26	24	3.50
17128	SL180	180	75	294	222	26	26	7.20
17129	SL250	250	85	331	251	30	30	10.5
17130	SL250Y	250	80	323	243	30	30	8.0

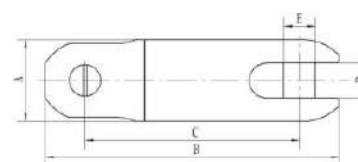

用途 / Uses

- ◆ 适用于导线、钢芯铝绞线放线时连接牵引钢丝绳，并能释放钢丝绳捻劲。
- ◆ Apply to connecting the conductor and ACSR with steel stranded rope in stringing construction. The product can release torsion strain accumulation of wire rope.

特点 / Feature

- ◆ 采用优质钢材，强度高，体积小，能通过放线滑车。
- ◆ Product is made of high strength steel with small size. It can pass through the stringing block.

■ 导线网套 / Conductor Mesh Sock Joints

产品编号 Item No.		型号 Model	适用导线 (LGJ) Applicable Conductor (ACSR)	负荷 (KN) Load	
单头 Single head	双头 Double head			额定 Rated	破坏 Breaking
17161	17181	SLW-1.5	70-95	15	30
17162	17182	SLW(S)-2	120-150	20	40
17163	17183	SLW(S)-2.5	185-240	25	50
17164	17184	SLW(S)-3	300-400	30	60
17165	17185	SLW(S)-4	500-630	40	80
17166	17186	SLW(S)-5	720	50	125
17167	17187	SLW(S)-7	900	70	175
17168	17188	SLW(S)-8	1000-1120	80	200



用途 / Uses

- ◆ 放线时连接和握紧各种钢芯铝绞线，能通过各类放线滑车及张力轮。
- ◆ Apply to connecting and grip various SCSR in releasing wires. It can pass through various stringing block or tensioning wheel.

■ 电缆网套 / Cable Mesh Sock Joints

产品编号 Item No.	型号 Model	适用电缆直径 (MM) Applicable Cable Diameter	额定负荷 (KN) Rated Load	产品编号 Item No.	型号 Model	适用电缆直径 (MM) Applicable Cable Diameter	额定负荷 (KN) Rated Load
21361	SWL-16	Φ12-16	8	21366	SWL-60	Φ50-60	15
21362	SWL-20	Φ16-20	10	21367	SWL-80	Φ60-80	20
21363	SWL-25	Φ20-25	12	21368	SWL-100	Φ80-100	25
21364	SWL-37	Φ25-37	18	21369	SWL-120	Φ100-120	30
21365	SWL-50	Φ37-50	28	21370	SWL-150	Φ120-150	30



用途 / Uses

- ◆ 用于电力电缆，通讯电缆和光缆的安装。
- ◆ Apply to installing electricity cable communication cable and normal cable.

■ 光缆防捻器 / Anti Twist Running Board

产品编号 Item No.	型号 Model	光缆直径 (MM) Applicable OPGW diameter	防扭力矩 (N.m) Anti twist moment	重量 (KG) Weight
20118	ZB1	Φ11.5-16	32	12.5
20118a	ZB2	Φ16-23	32	12.5
20118b	ZB3	Φ8-12	32	12.5



- ◆ For OPGW construction, two anti twist running board. the gap of anti twist running board is 2m to screw it on OPGW directly, can pass 660mm pulley groove..

用途 / Uses

- ◆ 用于OPGW施工。2套光缆防捻器为一组使用。光缆防捻器的间距为2m。直接将其拧在OPGW上，可以通过Φ660mm的放线滑车槽。

■ 光缆网套 / OPGWADSS Mesh Sock Joints

产品编号 Item No.	适用光缆直径 (MM) Applicable Optical Cable Diameter	额定负荷 (KN) Rated Load	长度 (M) Length
20105A	Φ7-11	10	1.4
20105B	Φ11-15	15	1.4
20105C	Φ15-17	20	1.4
20105D	Φ17-22	25	1.4



用途 / Uses

- ◆ 用于ADSS、OPGW光缆施工。
- ◆ Apply to ADSS or OPGW cable construction.

■ 一牵二走板 / Head Boards for Two Bundle Conductors

产品编号 Item No.	型号 Model	额定负荷 (KN) Rated Load	适用滑车轮宽 (MM) Applicable Sheave Width	重量 (KG) Weight	特征 Feature
17220	SZ2-8	80	75	17	导线各自独立 Conductor are independent
17221	SZ2-8A		100	19	
17222	SZ2-8B		110	19.5	
17223	SZ2A-8	80	100	90	平衡滑轮式 Poising sheave
17223T	SZ2A-8T		110	100	平衡滑轮式 Poising sheave
17224	SZ2B-13	130	110	55	导线各自独立 Conductor are independent
17225	SZ2C-13	130	110	50	导线各自独立 Conductor are independent
17226	SZ2B-18	180	125	90	导线各自独立 Conductor are independent



用途 / Uses

- ◆ 适用于张力架线或机械牵引架线施工。
- ◆ Apply to tension stringing or mechanical traction stringing construction.

说明 / Explain

- ◆ 特殊尺寸可定做。
- ◆ Special size can be customized.

■ 一牵三走板 / Head Boards for Three Bundle Conductors

产品编号 Item No.	型号 Model	额定负荷 (KN) Rated Load	适用滑车轮宽(MM) Applicable Stringing Block Sheave Width	重量 (KG) Weight	钢丝绳长度(M) Steel rop length
17228	SZ3A-10	100	100	114	1x30+1x15
17229	SZ3A-13	130	110	130	1x30+1x15
17230	SZ3A-18	180	110	142	1x30+1x15



特点 / Feature

- ◆ 用于张力架线电缆牵引敷设专业，防止线缆扭动的积累。
- ◆ They are designed to avoid torsion strain accumulation during line stringing.

说明 / Explain

- ◆ 可以根据滑车规格定制。
- ◆ Speical size can be customized.

■ 一牵四走板 / Head Boards for Four Bundle Conductors

产品编号 Item No.	型号 Model	额定负荷 (KN) Rated Load	适用滑车轮宽(MM) Applicable Sheave Width	重量 (KG) Weight	特征 Feature
17231	SZ4A-13	130	100	139	平衡滑轮式 Poising sheave
17232	SZ4B-13	130	100	82	导线各自独立 Conductor are independent
17233	SZ4B-18	180	110	95	导线各自独立 Conductor are independent
17234	SZ4B-25	250	110	105	导线各自独立 Conductor are independent
17239	SZ4B-32	320	125	150	导线各自独立 Conductor are independent



特点 / Feature

- ◆ 特殊尺寸可定做。
- ◆ Speical size can be customized.

■ 导线提线器 / Multiple Fission Conductor Lifter

产品编号 Item No.	型号 Model	额定负荷 (KN) Rated Load	钩槽长度 Hook slot length	重量 (KG) Weight	备注 Note
19112	ST25-2	2X12	120	13	双线 Two
19113	ST50-2	2X25	160	25	双线 Two
19114	ST80-2	2X40	250	40	双线 Two
19108	ST36-3	3X12	120	21	三线 Three
19109	ST75-3	3X25	160	35	三线 Three
19110	ST120-3	3X40	250	60	三线 Three
19115	ST48-4	4X12	120	35	四线 Four
19116	ST100-4	4X25	160	60	四线 Four
19117	ST160-4	4X40	250	90	四线 Four
19118A	ST150-6	6X25	160	70	六线 Sex
19118B	ST240-6	6X40	250	110	六线 Sex
19119A	ST200-8	8X25	160	120	八线 Eight
19119B	ST320-8	8X40	250	160	八线 Eight

用途 / Uses

- ◆ 用于双分裂导线、四分裂导线、六分裂导线、八分裂导线提升导线用。
- ◆ Lifting wire for two bundled conductors or four bundled conductors or sex bundled conductors or eight bundled conductors.



■ 放线支架 / Simple Reel Stand

产品编号 Item No.	型号 Model	额定负荷 (KN) Rated Load	高度调节范围 Height Adjustment Range	重量 (KG) Weight
15191	SIL-1	10	450-650	22
15192	SIL-3	30	600-900	24
15193	SIL-5	50	900-1300	27
15201	SIK-3	30	600-900	30
15202	SIK-5	50	900-1300	44
15211	SIL-3A	30	600-900	28
15212	SIL-5A	50	900-1300	35

用途 / Uses

- ◆ 用丝杆升降线盘、轻巧实用，适宜于人力放线。
- ◆ Apply to adjusting reel by screw mandrel. Product is used for wire releasing manual.

说明 / Explain

- ◆ 线盘轴另配购。
- ◆ Axle is need to buy in additional.



■ 液压放线架 / Hydraulic Type Cable Reel Stand

产品编号 Item No.	型号 Model	额定负荷 (KN) Rated Load	适用线盘 (MM) Applicable Cable Reel			重量 (KG) Weight
			盘径 Diameter	盘宽 Width	轴孔直径 Hole Diameter	
21346	SI-5	50	≤ Φ2400	≤1600	Φ76-103	172
21348	SI-10	100	≤ Φ3400	≤1900	Φ120-135	230
21343	SI-20	200	≤ Φ4000	≤2500	Φ135-160	450

用途 / Uses

- ◆ 适用于电缆线盘的支撑。
- ◆ Apply to carrying cable reel.

特点 / Feature

- ◆ 液压顶升，底脚装小轮，便于移动。
- ◆ Hydraulic lifter with small wheels in the bottom for easy moving.

说明 / Explain

- ◆ 标配含轴。
- ◆ Standard configuration, including shaft.



■ 组合式导线轴架 / Detachable Type Cable Reel Stand

产品编号 Item No.	型号 Model	额定负荷 (KN) Rated Load	适用线盘 (MM) Applicable Cable Reel			重量 (KG) Weight
			盘径 Diameter	盘宽 Width	轴孔直径 Hole Diameter	
15141	SIDZ-3	30	≤ Φ2000	≤1200	Φ65-80	150
15142	SIDZ-5	50	≤ Φ2400	≤1200	Φ76-103	240
15143	SIDZ-7	70	≤ Φ2500	≤1700	Φ120	450

用途 / Uses

- ◆ 用于线路施工中支撑线盘进行放线。
- ◆ During the construction of the line, the supporting cable reel is used for stringing construction.



■ 立式放线盘架 / Vertical Type Cable Reel Stand

产品编号 Item No.	型号 Model	盘径 (MM) Diameter	额定负荷 (KN) Rated Load	重量 (KG) Weight
15131	SIW-1	Φ500	1000	36
15132	SIW-3A	Φ800	3000	70
15133	SIW-3B	Φ1000	3000	102
15135	SIW-5A	Φ1500	5000	129

用途 / Uses

- ◆ 用于线路施工中支撑线盘进行放线。
- ◆ During the construction of the line, the supporting cable reel is used for stringing construction.

特点 / Feature

- ◆ 牵引导线时，线盘可自动旋转。
- ◆ When pulling the wire, the wire reel can rotate automatically.



■ 钢丝绳盘架 / Rope Reel And Stand

产品编号 Item No.		型号 Model	丝盘尺寸(MM) Reel Stand Dimension	重量 (KG) Weight	
盘 Reel	架 Stand			盘 Reel	架 Stand
15111	15101	SE-1	Φ480xΦ220x340	13	12
15112	15102	SE-2	Φ720xΦ400x640	30	16
15113	15103	SE-3	Φ850xΦ400x640	40	16
15114	15104	SE-4	Φ950xΦ400x640	50	20
15115	15105	SE-5	Φ1100xΦ400x640	55	30
15116	15106	SE-6	Φ1200xΦ400x640	59	39



用途 / Uses

- 用于回收或展放钢丝绳。
- Apply to loading steel rope.

■ GSP钢丝绳盘和船型架 / GSP Rope Reel And Stand

产品编号 Item No.		型号 Model	丝盘尺寸(MM) Reel Stand Dimension	重量 (KG) Weight	
盘 Reel	架 Stand			盘 Reel	架 Stand
07125A	07128A	950	Φ950xΦ400x450	48	20
07125B	07128B	1200	Φ1200xΦ570x560	65	30
07125C	07128C	1400	Φ1400xΦ570x560	74	40
07125D	07128D	1600	Φ1600xΦ570x560	102	50
07125E	07128E	1900	Φ1900xΦ570x560	119	70

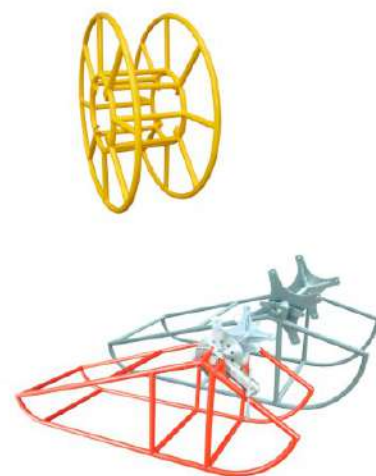

用途 / Uses

- 用于回收或展放钢丝绳。
- Apply to loading steel rope.

■ 防扭钢丝绳 / Anti-Twisting Braided Steel Rope

产品编号 Item No.	结构 Structure	方径 Diameter	破坏力 Breaking Force	参考重量 (KG/M) Weight
18117	六方十二股 12 Strand	9	≥64	0.3
18118		11	≥71	0.45
18119		13	≥87	0.58
18120		15	≥97	0.82
18121		18	≥97	1.03
18122		20	≥97	1.33
18123		23	≥172	1.63
18124		25	≥97	2.03
18125		27	≥97	2.37
18126		28	≥97	2.6
18127		30	≥172	3.12
18140		六方十八股 18 Strand	21	≥97
18141	24		≥97	1.24
18151	27		≥97	1.55
18152	30		≥172	1.99
18153	33		≥97	2.45
18154	36		≥97	3.05
18155	39		≥97	3.56
18156	42		≥172	4.22



用途 / Uses

- 适用于机械牵引放线或张力放线，不适用做小直径磨芯的牵引绳。
- Apply to mechanical traction and tensioning release conductors as pulling rope or leading rope. Not suitable for small winch traction.

特点 / Feature

- 采用高强度镀锌钢丝编织而成，在受拉转向时不会扭转，柔软不破股。
- Made of high strength galvanized steel wire. It doesn't turn when it's turn round. Soft not broken strand.

■ 迪尼玛绳 / Dyneema Rope

绳索直径 (MM) Diameter	线密度(G/M) Linear density	包护套后直径(MM) Sheath diameter	包护套后米重(G/M) Linear density	破断强度 (KN) Break force
4	9.31	5.5	13	16.6
6	20	8	28.2	31.9
8	35	10	48.4	58.8
10	56	12	77	92.5
12	84	14	113.4	137
14	106	16	150	180
16	132	18	177	211
18	186	21	247.3	296



说明 / Explain

- 材料为迪尼玛纤维，是比重最轻，强度最高的高性能纤维；
- 重量轻，强度高（同直径，同强度其重量不到钢丝绳1/7），使操作更方便快速；
- 耐压绝缘，是目前带电跨越最理想的产品。
- Material is Dinima fiber, is the lightest, the highest strength of high performance fiber.
- Light weight, high strength (same diameter, same strength, less than 1/7 of steel wire rope), make the operation more convention and fast;
- Voltage insulation, is the most ideal product of Live operation and crossing.

■ 绝缘锦纶绳 / Insulated Nylon Rope

直径 (MM) Diameter	断力负荷 (>N) Break force	绳密度(G/M) Linear density	直径 (MM) Diameter	断力负荷 (>N) Break force	绳密度(G/M) Linear density
6	864	20±0.3	16	4160	153±1.5
8	1280	44±0.5	18	5120	193±2
10	1760	63±1	20	6080	222±3
12	2400	93±1	22	7040	268±3
14	3232	117±1.5	24	8000	318±4



■ 铝合金链条手扳葫芦 / Aluminum alloy chain hand wrench Gourd

产品编号 Item No.	72201	72202	72203	72204	72205	72206
型号	MLSB-0.75	MLSB-1.5	MLSB-3	MLSB-4	MLSB-6	MLSB-9
工作能力(KN)	7.5	15	30	40	60	90
试验载荷(KN)	11.3	22.5	45.0	60.0	90.0	135.0
链条直径(mm)	5	5	6	6	6	7.1
收缩长(mm)	300	350	350	580	650	820
伸缩长(mm)	1800	1850	1850	2080	2150	2320
扬程(mm)	1500	1500	1500	1500	1500	1500
手柄长度(mm)	230	230	430	630	730	750
自重(kg)	4.7	5.8	9.5	14.5	18.0	24.0
超重高度每增加1米应增加的重量(kg)	0.55	1.10	1.70	2.10	2.80	3.2

用途 / Uses

- 适用于线路施工中紧线，调整弧垂，拉线及其它工作。在电力、造船、运输、建筑、矿山、邮电、通讯等部门的设备安装；小型物品的起吊、机件牵引等，尤其在狭小的工作场所、野外、高空作业和各种不同角度的牵引等，更具有独特的优越性。
- Suitable for tightening line, adjusting sag, pulling line and other work in line construction. In electric power, shipbuilding, transportation, construction, mining, post and telecommunications, communications equipment installation of other departments; Lifting small items, machinery traction, etc., especially in the narrow workplace, the field, high-altitude work and a variety of not, The same Angle of traction, etc., more unique advantages.

特点 / Feature

- 主体选用高强度铝合金材料，链条采用高强度特制合金钢材料，在设计与使用上具有使用方便、安全可靠；结构合理、造型美观；维修简单、经久耐用；手扳力小、工作效率高；体积特小、重量特轻、携带特方便的特点。
- The main body is made of high-strength aluminum alloy, and the chain is made of high-strength special alloy steel. Rely on; Reasonable structure and beautiful shape; Simple maintenance, durable; Small hand lever force, high work efficiency; Small size, light weight and portable. A convenient feature.



MLSB-0.75 MLSB-1.5 MLSB-3 MLSB-4



MLSB-6 MLSB-6X MLSB-9

棘轮紧线器 / Ratchet Withdrawing Wire Tighter

产品编号 Item No.	型号 Model	额定负荷(KN) Rated Load	紧线长度(MM) Tight-line Length	重量(KG) Weight
14102	SJJA-1	10	1200	3.5
14103	SJJA-2	20	1500	4.5
14104	SJJA-3	30	1500	6.0



用途 / Uses

- ◆ 与导线卡线器配合，收紧导线用。
- ◆ Apply to tightening conductor and using with conductor wire grip.

说明 / Explain

- ◆ 采用摩擦式结构，转动灵活可靠。
- ◆ It is adopted friction mechanism with reliable performance.

钢丝绳手扳葫芦 / Wire Rope Handle Hoist

产品编号 Item No.	14183	14184	14185	14186
型号 Model	HSS408	HSS416	HSS432	ISS454
额定提升/牵引(KN) Rated Lifting/Pulling	8/12.5	16/25	32/50	54
一次行程(MM) Once journey	≥40	≥40	≥16	≥20
钢丝绳直径(MM) Diameter of steel rope	Φ8	Φ11.6	Φ16	Φ22
钢丝绳标准长度(M) Standard length of steel rope	20	20	20	20
净重(KG) Net weight	6.8	13	25	52
额定负荷时手扳力(N) Hand wrenching at the rate load	≤343	≤400	≤441	≤550
装箱尺寸(MM) Encasement dimension	420x106x250	530x126x315	660x160x360	930x390x150



说明 / Explain

- ◆ 具有起重、牵引、张紧三大功能。适用于野外，无动力源状况下，较长距离的起重或牵引使用。
- ◆ It has three functions of lifting, pulling and tensioning. It is suitable for long distance lifting or pulling in the field without power source.

手扳葫芦 / Chain Type Handle Hoist

产品编号 Item No.	14201	14211	14215	14221	14231	14241	14245
额定负荷(KN) Rated load	5	7.5	10	15	30	60	90
两钩最小间距(MM) Minimum distance between hooks	260	320	380	380	480	620	700
标准起重高度(M) Standard lifting height	1.5						
起重链条行数(行) Number of lines of lifting chain(row)	1	1	1	1	1	2	3
净重(KG) Weight	4.2	7.5	11.5	11.5	21	31.5	47
产品编号 Item No.	链条3m Length of chain	14202	14212	14216	14222	14232	14242
	链条5m Length of chain	14204	14214	14218	14224	14234	14244
起重高度每1m链条重量(KG) Weight of 1m chain	0.52	0.8	1.4	1.4	2.2	4.4	6.6

用途 / Uses

- ◆ 适用于放线施工中的起重机械零件、钢绞线、铝绞线等。
- ◆ Apply to lifting machine parts, tightening steel stranded wire and aluminum stranded wire, etc. in line construction.

绝缘紧线器 / Insulated tightener

产品编号 Item No.	型号 Model	额定提升/牵引负荷(KN) Rated Lifting/Pulling	织带厚度×长度(MM) Webbing thickness×length	最小长度(MM) Min length	最大长度(MM) Max length	重量(KG/M) Weight
14106	SJY-1.5	15/7.5	6*2300	480	1400	4.2

说明 / Explain

- ◆ 绝缘紧线器使用不导电玻璃钢绝缘手柄及软质的耐腐蚀与高张力织带来代替钢丝绳，带电作业时用于紧线，耐电压15千伏(3分钟)。
- ◆ The Insulated tightener uses non-conductive FRP insulated handle and soft corrosion-resistant and high tension woven belt to replace the steel wire rope. It is used for wire tightening during live line operation, and the voltage resistance is 15 kV (3 minutes).



■ 钢双钩紧线器 / Dual-Hook Steel Turnbuckle

产品编号 Item No.	型号 Model	额定负荷(KN) Rated Load	最大中心距(MM) Max Center Distance	调节距离(MM) Adjustable Distance	重量(KG) Weight
14111	SJS-0.5	5	800	250	2.5
14112	SJS-1	10	860	300	3.5
14113	SJS-2	20	1050	340	4
14114	SJS-3	30	1350	470	6
14115	SJS-5	50	1440	510	8
14116	SJS-8	80	1670	560	8.5
14117	SJS-10	100	1740	600	10



用途 / Uses

- ◆ 适用于收紧导线、安装拉线、钢丝绳、钢绞线及更换绝缘子等。
- ◆ Apply to tightening conductor, steel wire rope or steel stranded wire on installing stay wire and replacing insulator string.

■ 铝合金双钩紧线器 / Dual-Hook Aluminium Alloy Turnbuckle

产品编号 Item No.	型号 Model	额定负荷(KN) Rated Load	最大中心距(MM) Max Center Distance	调节距离(MM) Adjustable Distance	重量(KG) Weight
14121	SJSL-1	10	798	290	2
14122	SJSL-2	20	936	350	2.5
14123	SJSL-3	30	1296	530	4.5
14124	SJSL-5	50	1500	630	6



用途 / Uses

- ◆ 用于收紧钢丝绳、钢绞线等。
- ◆ Apply to tightening conductor, steel wire rope or steel stranded wire on installing stay wire and replacing insulator string.

■ 格构式内悬浮抱杆 / Inner-suspended Lattice Gin Pole

产品编号 Item No.	型号 Model	范围(M) Range	断面(MM) Section	主材尺寸(MM) Main part size	辅材尺寸(MM) Accessory size	允许轴向负荷(KN) Vertical Load	安全系数(K) Safety Factor	重量(KG/M) Weight
03131	LBNX-300A	8-16	300*300	50*50*4	25*25*3	13-38	2.5	10.5
03141	LBNX-300B	11-18	300*300	50*50*5	30*30*3	15-40	2.5	11.0
03151	LBNX-400	12-20	400*400	50*50*5	30*30*3	14-43	2.5	14.6
03511	LBNX-500A	12-20	500*500	60*60*5	30*30*3	34-75	2.5	18
03515	LBNX-500B	14-22	500*500	60*60*5	40*40*3		2.5	20
03521	LBNX-500C	15-23	500*500	70*70*6	40*40*3	42-88	2.5	21
03525	LBNX-500D	17-25	500*500	70*70*6	50*50*4		2.5	22
03531	LBNX-600A	15-23	600*600	60*60*6	40*40*3	38-75	2.5	20
03535	LBNX-600B	17-25	600*600	70*70*6	40*40*3		2.5	21
03541	LBNX-600C	17-25	600*600	70*70*6	50*50*4	58-119	2.5	22
03545	LBNX-600D	17-25	600*600	80*80*6	50*50*4		2.5	24
03601	BNX-300	10-15	300*300	50*50*5	30*30*3	17-35	2.5	33
03602	BNX-400	12-16	400*400	50*50*5	30*30*3	29-51	2.5	43
03603	BNX-500	16-24	500*500	63*63*5	40*40*4	41-93	2.5	54
03604	BNX-600	16-32	600*600	70*70*6	40*40*4	72-221	2.5	63
03605	BNX-700	20-32	700*700	80*80*6	50*50*4	115-294	2.5	75

用途 / Uses

- ◆ 用于输电线路施工中加拉线后立杆塔。
- ◆ Apply to assemble and erect the tower and pole in transmission line construction.

说明 / Explain

- ◆ 03131-03545为铝合金材质, 03601-03605为锰钢材质。
- ◆ 03131-03545 is aluminum alloy material. 03601-03605 is manganese steel material.



■ 格构式人字抱杆 / A-shape Lattice Gin Pole

产品编号 Item No.	型号 Model	范围(M) Range	断面(MM) Section	主材尺寸(MM) Main part size	辅材尺寸(MM) Accessory size	允许轴向负荷(KN) Vertical Load	安全系数(K) Safety Factor	重量(KG/M) Weight	
03361	LBR-250	8-13	250*250	50*50*4	25*25*3	26-72	2.5	10.5*2	
03371	LBR-300A	8-16	300*300	50*50*4	25*25*3	26-90	2.5	10.5*2	
03380	LBR-300B		300*300	50*50*5	30*30*3		2.5	11.0*2	
03381	LBR-350	8-16	350*350	50*50*5	30*30*3	35-120	2.5	10.5*2	
03391	LBR-400A	11-18	400*400	50*50*5	30*30*3	38-147	2.5	11.0*2	
03401	LBR-400B		400*400	60*60*5	30*30*3		2.5	14.6*2	
03411	LBR-500A	13-20	500*500	60*60*5	30*30*3	81-162	2.5	18*2	
03415	LBR-500B		500*500	60*60*5	40*40*3		2.5	20*2	
03421	LBR-500C		500*500	70*70*6	40*40*3		127-256	2.5	21*2
03425	LBR-500D		500*500	70*70*6	50*50*4			2.5	22*2
03431	LBR-600A	15-22	600*600	60*60*6	40*40*3	96-171	2.5	20*2	
03435	LBR-600B		600*600	70*70*6	40*40*3		2.5	21*2	
03441	LBR-600C		600*600	70*70*6	50*50*4		150-275	2.5	22*2
03445	LBR-600D		600*600	80*80*6	50*50*4			2.5	24*2
03611	GBR-300	10-15	300*300	50*50*5	30*30*3	35-75	2.5	33*2	
03612	GBR-400	12-18	400*400	56*56*5	30*30*3	75-100	2.5	43*2	
03613	GBR-500	14-24	500*500	63*63*5	40*40*4	125-185	2.5	54*2	
03614	GBR-600	16-26	600*600	70*70*6	40*40*4	145-420	2.5	63*2	
03615	GBR-700	18-28	700*700	80*80*6	50*50*4	230-600	2.5	75*2	

用途 / Uses

- 用于输配电线路施工上加拉线后组立杆塔。

- Apply to assemble and erect the tower and pole in transmission line construction.

说明 / Explain

- 抱杆头部分为倒落式、固定式、倒落固定两用式；底座部分为半圆形或方形订货时应注明。
- 03361-03445为铝合金材质，03611-03615为锰钢材质。

- The head part of the Gin Poles is inverted, and The base part of the gin pole is semicircle or square. And it should be noted when ordering.
- 03361-03445 is aluminum alloy material. 03611-03615 is manganese steel material.



■ 管式内悬浮抱杆 / Inner-Suspended Tubular Gin Pole

产品编号 Item No.	型号 Model	长度(M) Length	管径x壁厚(MM) Diameter*wall	允许轴向负荷(KN) Vertical Load	安全系数(K) Safety Factor	重量(KG/M) Weight
03101	LBNXG120	9-11	120x7	5-9	2.5	7.5
03111	LBNXG150	9-11	150x6	10-15	2.5	

用途 / Uses

- 用于输电线路施工中整体吊装组立杆塔。
- Apply to assemble and erect the tower and pole in transmission line construction.

■ 管式人字抱杆 / A-Shape Tubular Gin Pole

产品编号 Item No.	型号 Model	长度(M) Length	管径x壁厚(MM) Diameter*wall	允许轴向负荷(KN) Vertical Load	安全系数(K) Safety Factor	重量(KG/M) Weight
03311	LBGR120A	6-9	120x7	17-30	2.5	7.5
03321	LBGR150A	8-13	150x6	13-31	2.5	8

用途 / Uses

- 用于输电线路施工中整体起立小型单杆或起吊一般重量的部件。
- Apply to set up small single pole in transmission line construction or lifts light weight parts.

说明 / Explain

- 抱杆头部分为倒落式、固定式、倒落固定两用式；订货时应注明。
- The head part of the Gin Poles is inverted, and it should be noted when ordering.

■ 单线飞车 / Inspection Trolleys and Overhead Lines Bicycles for Single Conductor

产品编号 Item No.	型号 Model	额定负荷(KN) Rated Load	轮径(MM) Diameter of Sheave	最大通过直径(MM) Maximum through diameter	重量(KG) Weight
17261	SFD1A	1	Φ80	Φ40	7
17262	SFD1B	1	Φ80	Φ40	7
17263	SFD	1	Φ160	Φ70	34
17264	SFD3	1	Φ160	Φ40	34

用途 / Uses

- 用于单导线上安装附件及检修等；17263的结构形式为框式。
- Apply to install accessories and inspection on single conductor; The structural form of 17263 is frame platform.



■ 双线飞车 / Inspection Trolleys and Overhead Lines Bicycles for Two Bundle Conductors

产品编号 Item No.	型号 Model	额定负荷(KN) Rated Load	最大通过直径(MM) Maximum through diameter	导线间距(MM) Conductors distance	重量(KG) Weight	备注 Remark
17251	SFS2	1	Φ40	400	34	水平双线 Horizontal
				450	36	
				500	38	
17253	SFS400	1	Φ40	400	40	垂直双线 Vertical
17255	FC400/450S	1	Φ60	400-450	34	水平双线 Horizontal
17256	SFS1-400	1.5	Φ70	400	38	水平双线 Horizontal
17257	SFS1-450			450	40	

用途 / Uses

- 用于双分裂导线安装附件及检修等。
- Used for installation accessories and maintenance of double split conductors.

说明 / Explain

- 订货时请注明导线间距。
- Please indicate the wire spacing when ordering.

■ 四线飞车 / Inspection Trolleys and Overhead Lines Bicycles for Four Bundle Conductors

产品编号 Item No.	型号 Model	额定负荷(KN) Rated Load	最大通过直径(MM) Maximum through diameter	导线间距(MM) Conductors distance	重量(KG) Weight
17271	SFS1	1.5	Φ70	450	40
				500	
17272	SFS3	1	Φ40	400	36
				450	38
				500	40
17273	FCS400/450	1	Φ60	400-450	43.5

用途 / Uses

- 用于双分裂导线安装附件及检修等。
- Used for installation accessories and maintenance of double split conductors.

说明 / Explain

- 订货时请注明导线间距。
- Please indicate the wire spacing when ordering.

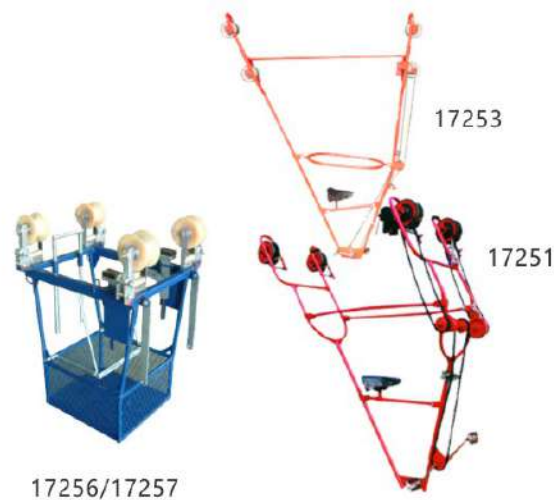

17256/17257



17271

17272

■ 剥皮器 / Cable Stripper

产品编号 Item No.	型号 Model	绝缘导线外径(MM) Insulated Conductor Diameter	绝缘层厚度(MM) Insulating Layer	重量(KG) Weight	备注 Remark
21481	BP40	≤30	≤4.5	0.8	端末及中间剥除 Ending Or Middle Stripping
21482	BK40	≤40	≤12	0.8	
21483	BK65	≤65	≤15	1	
21451	BK105	≤105	≤30	3.5	
21452	BK160	≤160	≤35	5	

用途 / Uses

- 适用于绝缘导线绝缘层及电缆半绝缘层的剥离，而且不会损坏绝缘层。
- Apply to stripping the insulation layer of insulated conductor and the semi-insulation layer of cable and it will not damage the insulation layer.

■ 导线外层铝股剥切刀 / Stripping Knife to External Aluminum Strands of Conductor

产品编号 Item No.	型号 Model	适用导线(MM) Applicable Conductor	束线规格(LGJ) ACSR Specification	重量(KG) Weight
16281	LX400	240-400	150, 185, 240, 300, 400	4
16282	LX720	500-720	500, 630, 720	4.5
16283	LX900	185-900	-	8.0

用途 / Uses

- 适用于剥切钢芯铝绞线铝股。
- Apply to stripping the aluminum strands of ACSR.

■ 齿轮导线剪 / Conductor Cutter

产品编号 Item No.	型号 Model	剪切范围 Cutting Range
16241	SU-J	剪断400mm ² 以下钢芯铝绞线, 剪断80mm ² 以下钢绞线 Cutting ACSR with section below 400mm ² . Cutting steel strand with section below 80 mm ² .
16242	SUA-J	剪断720mm ² 以下钢芯铝绞线, 剪断120mm ² 以下钢绞线 Cutting ACSR with section below 720mm ² . Cutting steel strand with section below 120mm ² .
16243	SUB-J	剪断1000mm ² 以下钢芯铝绞线, 剪断150mm ² 以下钢绞线 Cutting ACSR with section below 1000mm ² . Cutting steel strand with section below 150mm ² .
16244	SUC-J	剪断1450mm ² 以下钢芯铝绞线, 剪断180mm ² 以下钢绞线 Cutting ACSR with section below 1450mm ² . Cutting steel strand with section below 180mm ² .



■ 电缆剪 / Cable Cutter

产品编号 Item No.	型号 Model	剪切范围 Cutting Range
21442B	Cc325	剪断240mm ² 以下铜铝电缆, 最大开口Φ32mm ² Cutting Off Copper Or Aluminum Cable below 240mm ² , Maximum opening Φ32mm ²
21442A	J40B	剪断240mm ² 以下铜铝电缆, 最大开口Φ32mm ² Cutting Off Copper Or Aluminum Cable below 240mm ² , Maximum opening Φ32mm ²
21442C	J40A	剪断300mm ² 以下铜铝电缆, 最大开口Φ40mm ² Cutting Copper Or Aluminum cable below 300mm ² , Maximum opening Φ40mm ²
21445	J40	剪断300mm ² 以下铜铝芯铠装电缆, 最大开口Φ40mm ² Cutting Copper Or Aluminum armored cable below 300mm ² , Maximum opening Φ40mm ²
21445A	J52	剪断500mm ² 以下铜铝芯铠装电缆, 最大开口Φ52mm ² Cutting Copper Or Aluminum armored cable below 500mm ² , Maximum opening Φ52mm ²
21445B	J75	剪断外径Φ75mm以下铜铝芯铠装电缆 Cutting Copper and Aluminum armored cables diameter below Φ75mm
21441	J95	剪断外径Φ95mm以下铜铝芯铠装电缆 Cutting Copper and Aluminum armored cables diameter below Φ95mm
21441A	J100	剪断外径Φ100mm以下铜铝芯铠装电缆 Cutting Copper and Aluminum armored cables diameter below Φ100mm
21440	J130	剪断外径Φ130mm以下铜铝芯铠装电缆 Cutting Copper and Aluminum armored cables diameter below Φ130mm
21440A	J160	剪断外径Φ160mm以下铜铝芯铠装电缆 Cutting Copper and Aluminum armored cables diameter below Φ160mm



用途 / Uses

- 用于切断电力电缆, 通信电缆等。
- Apply to cutting electricity cable or communication cable etc.

■ 线缆剪 / Conductor Cutter and Steel Wire Cutter

产品编号 Item No.	型号 Model	剪切范围 Cutting Range
16247	J30	剪断630mm ² 以下钢芯铝绞线, 剪断100mm ² 以下钢绞线 Cutting ACSR with section below 630mm ² . Cutting steel strand with section below 100mm ² .
16246	J13	剪断720mm ² 以下钢芯铝绞线, 剪断150mm ² 以下钢绞线 Cutting ACSR with section below 720mm ² . Cutting steel strand with section below 150mm ² .
16245	J25	剪断800mm ² 以下钢芯铝绞线, 剪断150mm ² 以下钢绞线 Cutting ACSR with section below 800mm ² . Cutting steel strand with section below 150mm ² .
16248	J50	剪断1440mm ² 以下钢芯铝绞线, 剪断180mm ² 以下钢绞线 Cutting ACSR with section below 1440mm ² . Cutting steel strand with section below 180mm ² .
16237	J14	剪断Φ20mm以下钢丝绳 Cutting steel rope section diameter below Φ20 mm
16238	J25A	剪断Φ30mm以下钢丝绳 Cutting steel rope section diameter below Φ30 mm
16239	J33	剪断Φ33mm以下钢丝绳 Cutting steel rope section diameter below Φ33 mm



■ 角钢切断器 / Angel Steel Cutter

产品编号 Item No.	型号 Model	冲裁范围 Blanking Range	冲头行程 Punching Stroke	重量(KG) Weight
06195	JQJ50×5	≤50×5	20	7
06196	JQJ70×5	≤70×5	25	10

用途 / Uses

- 用于电力线路施工, 建筑等野外高空作业时手动切断角钢。
- Apply to cutting angel steel by manual on aloft work of line construction or buliding construction.

特点 / Feature

- 结构简单易维修, 便于携带, 切断力大。
- It has simple structure and easy maintenance with strong shearing force. Easy to carry.



■ 机械冲孔 / Manual Puncher

产品编号 Item No.	型号 Model	喉深(MM) Notch Length	冲孔厚度(MM) Punching Thickness	冲模配置(MM) Punching Moulds Specification	主体材料 Main material	重量(KG) Weight
06191	CKG-1	40	≤9	Φ13Φ15Φ17 Φ19Φ21	钢 Steel	17
06192	CKG-2				铝合金 Aluminium alloy	13

用途 / Uses

- 适用于在塔料、横担等角钢上冲孔作业。
- Apply to punching holes manually.

说明 / Explain

- 配有专业包装箱。
- Package in Plastic box.



■ 高空压接钳 / High altitude Crimping Tool

产品编号 Item No.	型号 Model	最大压接力(KN) Maximum Compression	适用导线(LJ-LGJ) Applicable Conductor	重量(KG) Weight
16215	SYG-100	100	LGJ35-240	4.5
16211	SYX-150	150	LGJ35-240	7.2

用途 / Uses

- 高空压接钳适用于高空作业。
- Small, light and easy operation, applied to working high above the ground



■ 双卷筒绞磨 / Double Drum Winch

产品编号 Item No.	09151	09152	09162
型号 Model	JJCS-30	JJQS-30	JJCS-50
发动机 Engine	型号 Model	R175A柴油机 Diesel Engine	Gx270汽油机 Gasoline Engine
	功率(HP)Power	6	9
	转速(RPM)Speed	2600	3600
牵引(KN) Pullforce/ 牵引速度 (M/MIN) speed	慢档 Slow	30/5.7	30/7.43
	中档 Moderate	18.9/9.1	19.2/11.8
	快档 Fast	7.6/22.7	7.2/31.4
	倒档 Reverse	-/6.5	-/8.4
卷筒底径(MM) Drum bottom of groove diameter	Φ230	Φ230	Φ300
外形尺寸(MM)outline size	1000x670x600	1000x670x600	2230x1210x1135
重量(KG)Weight	305	270	700



用途 / Uses

- 适用于线路施工中的立塔、牵引放线、紧线作业、敷设电缆。
- Suitable for the construction of the tower line, traction line, tight line operation, laying cable.

说明 / Explain

- 动力可根据用户要求配置。
- Power can be configured according to used requirements.

■ 手扶拖拉机绞磨 / Walking Tractor Winch

产品编号 Item No.	型号 Model	离地间隙(MM) Ground Clearance	轮距(MM) Wheel-base	发动机功率(HP) Power	发动机转速(RPM) Speed	行驶速度(KM/H) Travel speed	外形尺寸(MM) Outline size	重量(KG) Weight
09171	12-A	150	1040	15	2000	3-13	2670x1040x1300	550
09172	12-B	150	1040	15	2000	3-13	2670x1040x1300	600

档位 Gear	I	II	III	IV	倒reversal I	倒reversal II
牵引力(T)Traction force	60	37	20	12	/	/
牵引速度(M/MIN)Traction speed	11.7	18.9	34.4	55.6	6.2	21.3

特点 / Feature

- 手扶拖拉机绞磨由12型手扶拖拉机改制而成，结构简单操作方便，用于输电线路施工中立塔、架线等作业。
- Restructured from the model 12 hand tractor, simple structure, easy operation widely used for pylon-conductor setting in power line construction.

■ 电缆输送机 / Cable Conveyor

产品编号 Item No.	型号 Model	电机功率 (KW) Motor Power	夹紧力 (KN) Clamping force	输送力 (KN) Pull Force	输送速度 (M/MIN) Conveying speed	外形尺寸 (MM) Outline size	使用电缆直径 (MM) Diameter of cable	电源(V) Supply Voltage	重量 (KG) Weight
21103	DCS-5	1.1*2	≤2.7	7	9	950*500*400	30-180	380	150
21105	DCS-8B	1.5*2	≤2.7	9	6	1000*530*400	30-200	380	195

特点 / Feature

- 本机适合在城市电网改造和新建设电缆用，尤其适合长距离的电缆施放，降低劳动强度，提高工程质量。
- The machine is suitable for urban power network reconstruction and new laying of cables, especially suitable for long distance cable release, reducing labor intensity, and also improving the quality of the project.
- 本机推力大，体积小，便于放在工井中施工用，自重轻。
- The thrust of the machine is large and small, easy to be put the construction of the well, and its weight is light.
- 本机可以单机单推，也可数机串推，通过一个控制箱来控制多台机器的同步性。
- The machine can be pushed by single machine, and also can be connected in series with a machine, and the synchronization of several machines is controlled by a control box.
- 输送轮为橡胶压铸成形，不会损坏电缆的外皮，同时可以根据外径大小调节中心的距离。
- The conveyor wheel is made of rubber die casting, which will not damage the cable sheath, and adjust the center distance according to the external diameter of the cable.



■ 整体式液压钳 / Integral Hydraulic Crimping Pliers

产品编号 Item No.	YQK-70	YQK-120	YQK-240	YQK-300
压接范围 (MM ²) Crimping Range	CU 4-70	CU 10-120	CU 16-240	CU 16-300
出力 (KN) Crimping Force	60	80	120	130
压接形式 Crimping Type	六角式 Hexagon	六角式 Hexagon	六角式 Hexagon	六角式 Hexagon
行程 (MM) Stroke	10	14	22	22
储油量 (MM) Oil Capacity	310	425	500	500
重量 (KG) Weight	2.8	4.0	6.3	6.5
模具配置 (MM ²) Standard Accessories	4,6,10,16,25,35,50,70	10,16,25,50,70,95,120	16,25,50,70,95,120,150,185,240	16,25,50,70,95,120,150,185,240,300

产品编号 Item No.	EP-300	EP-430	EP-510
压接范围 (MM ²) Crimping Range	CU 5-300	CU 50-400	CU 50-400
出力 (KN) Crimping Force	60	120	130
压接形式 Crimping Type	六角式 Hexagon	六角式 Hexagon	六角式 Hexagon
行程 (MM) Stroke	17	32	38
储油量 (CC) Oil Capacity	-	145	200
重量 (KG) Weight	3.2	6.5	6.8
模具配置 (MM ²) Standard Accessories	50,70,95,120,150,185,240,300	50,70,95,120,150,185,240,300,400	50,70,95,120,150,185,240,300,400



■ 分体式液压压接钳 / Split-type Hydraulic Crimping Pliers

产品编号 Item No.	16101	16101A	16101B	16101C
产品型号 Model	CO-630B	CO-630A	CO-1000	CO-400
出力 Crimping force	300KN	350KN	550KN	200KN
压接范围 Crimping range	150-630m	150-630mm ²	400-1000mm ²	16-400mm ²
压接类型 Crimping type	六角围压 Hexagon Crimping	六角围压 Hexagon Crimping	六角围压 Hexagon Crimping	六角围压 Hexagon Crimping
模具 Dies	150, 185, 240, 300, 400, 500, 630mm ²	150, 185, 240, 300, 400, 500, 630mm ²	400, 500, 630, 800, 1000mm ²	16, 25, 35, 50, 70, 95, 120, 150, 185, 240, 300, 400mm ²
行程 Stroke	24mm	24mm	26mm	24mm
高度 Height	approx.275mm	approx.350mm	approx.400mm	approx.250mm
重量 Weight	approx.N.W11.5KG G.W20KG	approx.N.W16.7KG G.W25.5KG	approx.N.W32KG G.W39KG	approx.N.W5.4KG G.W10KG
包装 Package	木箱 Wooden Case	木箱 Wooden Case	木箱 Wooden Case	纸箱 Paper Box

说明 / Explain

- 配手动泵或电动液压泵(70MPa).
- Working with a manual hydraulic pump or an electric hydraulic pump(70MPa).

产品编号 Item No.	16103	16103A	16104	16105	16106
产品型号 Model	YJD-600	YJD-1000	YDJ-1250	YJD-2000	YJD-3000
出力 (KN) Crimping force	60T	100T	125T	200T	300T
压接范围 (MM ²) Crimping range	14-55mm	14-76mm	14-76mm	14-90mm	14-100mm
压接类型 Crimping type	六角围压 Hexagon crimping	六角围压 Hexagon crimping	六角围压 Hexagon crimping	六角围压 Hexagon crimping	六角围压 Hexagon crimping
行程 Stroke	24mm		24mm	35mm	35mm
高度 Height	approx.370mm		approx.480mm		
重量 Weight	NW20KG GW30KG	NW30KG GW40KG	NW50KG GW60KG	NW85KG GW95KG	NW120KG GW130KG
包装 Package	木箱 Wooden Case	木箱 Wooden Case	木箱 Wooden Case	木箱 Wooden Case	木箱 Wooden Case

说明 / Explain

- 配电动液压泵或汽油动力液压泵(80MPa).
- Working with an electric hydraulic pump or a petrol power hydraulic pump (80 Mpa)



■ 液压电缆剪 / Integral Hydraulic Cable Cutter

产品编号 Item No.	HP-45	HP-55	HP-85
剪切范围 Cutting Range	Φ45MM以内的铜/铝/钢芯铝绞线 Φ20MM的钢棒、钢绞线 Φ45MM CU/AL / ACSR / Cable; Φ20MM Steel Bar, prestressed Steel Wire	Φ55MM以内的铜/铝/钢芯铝绞线、 钢绞线Φ22MM的钢棒 Φ55MM CU/AL / ACSR / Cable, Prestressed Steel Wire Φ22MM Steel Bar	Φ85MM以内铜铝电缆 Φ85MM Cuial Cable;
重量(KG) Weight	4.7	9.3	5.82
出力(KN) Crimping Force	70	130	100
额定压力(Rated Pressure)	700Bar(10000PSI)	700Bar(10000PSI)	700Bar(10000PSI)

产品编号 Item No.	HP-30C	HP-105C
剪切范围 Cutting Range	Φ30MM以内铠装铜铝电缆,Φ19MM内钢芯铝绞线 Φ30MM Armored CU/AL Cable, Φ19MM ACSR Cable	Φ85MM以内的铠装电缆, Φ105MM以内的铜铝电缆 Φ85MM Armored CU/AL Cable, Φ105MM Cuial Cable
重量(KG) Weight	3.95	11.6
出力(KN) Crimping Force	60	120
额定压力(Rated Pressure)	700Bar(10000PSI)	700Bar(10000PSI)



■ 分体式液压电缆剪 / Split-type Hydraulic Cable Cutter

产品编号 Item No.	P-45	P-55	HP-85
剪切范围 Cutting Range	Φ45MM以内的铜/铝/钢芯铝绞线 Φ20MM的钢棒 Φ45MM CU/AL / ACSR / Cable; Φ20MM Steel Bar	Φ55MM以内的铜/铝/钢芯铝绞线、 Φ22MM的钢棒 Φ55MM CU/AL / ACSR / Cable, Φ22MM Steel Bar	Φ85MM以内的铜铝铠装电缆 Φ85MM Light-armored CU/AL Cable
重量(KG) Weight	3.8	4.5	4.8
出力(KN) Crimping Force	60	120	80
额定压力(Rated Pressure)	700Bar(10000PSI)	700Bar(10000PSI)	700Bar(10000PSI)

产品编号 Item No.	P-105	P-120	P-132	P-160
剪切范围 Cutting Range	Φ105MM 铜/铝/电缆, 30*300MM ² 铠装电缆 Φ105MM CU/AL Cable, 3x300MM ² Armored Cable	Φ120MM 铜/铝/ 铠装电缆 Φ120MM CU/AL / Armored / Cable	Φ132MM 铜/铝/ 铠装电缆 Φ132MM CU/AL / Armored / Cable	Φ160MM 铜/铝/ 铠装电缆 Φ160MM CU/AL / Armored / Cable
重量(KG) Weight	7.5	11	12	16
出力(KN) Crimping Force	120	120	130	170
额定压力(Rated Pressure)	700Bar(10000PSI)	700Bar(10000PSI)	700Bar(10000PSI)	700Bar(10000PSI)

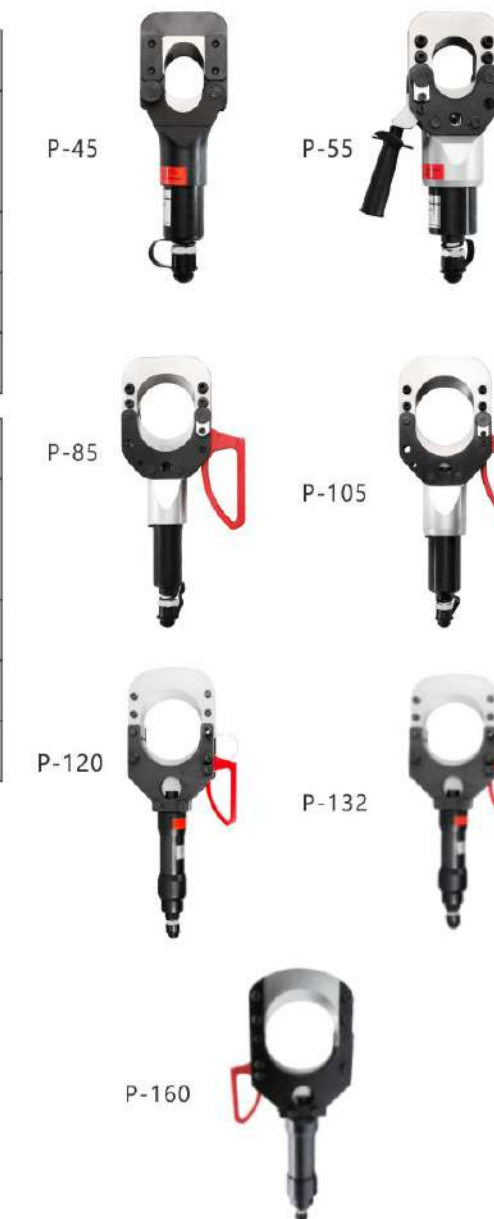

■ 充电式液压电缆剪刀 / Rechargeable Hydraulic Cable Cutter

产品编号 Item No.	NC-32	NC-65	NC-85
剪切范围 Cutting Range	Armored CU/AL Cable ≤Φ28MM ACSR ≤240MM ²	Armored Cable ≤Φ45MM CU/AL Cable ≤Φ65MM	Armored Cable ≤Φ65MM CU/AL Cable ≤Φ85MM
出力 (KN) Crimping Force	60	70	120
电池 Battery	DC 18V 4.0AH LI-ION	DC 18V 4.0AH LI-ION	DC 18V 4.0AH LI-ION
充电电压 Voltage Ofcharge	AC 110V-240V	AC 110V-240V	AC 110V-240V
充电时间 Charging Time	2 HOURS	2 HOURS	2 HOURS
行程 (MM) Ram Stroke	21	65	85
电机 Motor	DC18V	DC18V	DC18V
切割能力 Cutting Capacity	铝线 Alstrands: 28MM(240MM ²) 铜线 CU Strands: 28MM(250MM ²) 钢芯铝绞线 ACSR: 240MM ²	铝线 Alstrands: 65MM 铜线 CU Strands: 65MM 铠装电缆 Armored Cables: 45MM	铝线 Alstrands: 85MM 铜线 CU Strands: 85MM 铠装电缆 Armored Cables: 65MM



产品编号 Item No.	NC-105	NC-120	NC-135
剪切范围 Cutting Range	Armored Cable ≤Φ85MM CU/AL Cable ≤Φ105MM	Armored Cable ≤Φ100MM CU/AL Cable ≤Φ120MM	Armored Cable ≤Φ115MM CU/AL Cable ≤Φ135MM
出力 (KN) Crimping Force	170	200	210
电池 Battery	DC 18V 5.0AH LI-ION	DC 18V 5.0AH LI-ION	DC 18V 5.0AH LI-ION
充电电压 Voltage Ofcharge	AC 110V-240V	AC 110V-240V	AC 110V-240V
充电时间 Charging Time	2 HOURS	2 HOURS	2 HOURS
行程 (MM) Ram Stroke	105	120	135
电机 Motor	DC18V	DC18V	DC18V
切割能力 Cutting Capacity	铝线 Alstrands: 105MM 铜线 CU Strands: 105MM 铠装电缆 Armored Cables: 85MM	铝线 Alstrands: 120MM 铜线 CU Strands: 120MM 铠装电缆 Armored Cables: 100MM	铝线 Alstrands: 135MM 铜线 CU Strands: 135MM 铠装电缆 Armored Cables: 115MM

说明 / Explain

◆ 配件: 肩带、手提箱、电池和充电器

◆ Accessories: shoulder strap, double molded carrying case, battery and charger

■ 电动压接钳 / Electric Crimping Pliers

产品编号 Item No.	EM-300	一次充电压接次数 Crimping Times	Approx.120 Times (CU 150MM ²)
压接范围 Crimping Range	CU 300MM ² /AL 200MM ²	充电时间 Charge/once	2 Hours
出力 Crimping Force	70KN	包装 Package	Plastic box
行程 Str Oke	17MM	模具 Crimping Dies	16,25,35,50,70,95,120,150, 185,240,300MM ²
环境温度 Ambient Temperature	-10-40°C	电池 Battery	2PCS
电压 Voltage	18V	充电器 Charger	1PC
压接周期 Crimpionce	6-18S (Depend on the size of cable)		



EM-300 EP-300

产品编号 Item No.	EP-300	NE-300	NE-400	NE-630
压接范围 Crimping Range	CU 300MM ² /AL 200MM ²	CU 16-300MM ²	CU 16-400MM ²	25-630MM ²
出力 Crimping Force	60KN	60KN	120KN	200KN
压接形式 Crimping Type	Hexagon crimping	Hexagon crimping	Hexagon crimping	Hexagon crimping
行程 Stroke	17MM	17MM	42MM	20MM
充电/次 Crimp/Charge	170 Times (CU 150MM ²)	170 Times (CU 150MM ²)	170 Times (CU 150MM ²)	30 Times (CU 150MM ²)
切割时间/次 Crimping Cycle	10-15S (Depend on the size of cable)	10-15S (Depend on the size of cable)	10-15S (Depend on the size of cable)	10-15S (Depend on the size of cable)
电压 Voltage	18V 4.0AH LI-ION	18V 4.0AH LI-ION	18V 4.0AH LI-ION	18V 5.0AH LI-ION
充电次数 Charging Times	2 Hours	2 Hours	2 Hours	2 Hours
包装 Package	Plastic Case	Plastic Case	Plastic Case	Plastic Case
模具 Crimping Dies	16,25,35,50,70,95,120, 150,185,240,300MM ²	16,25,35,50,70,95,120, 150,185,240,300MM ²	16,25,35,50,70,95,120, 150,185,240,300MM ²	25,35,50,70,95,120,150, 185,240,300,400,500, 630,MM ²
电池 Battery	2PCS	2PCS	2PCS	2PCS
充电器 Charger	1PC	1PC	1PC	1PC



NE-300 EP-400



NE-630

■ 超高压液压泵站 / Hydraulic Pump Station

型号 Model	SY-BQ-80		
发动机(KW) Engine(kw)	Gx200 3.7KW	换向阀结构型式 Directional Valve Structural Type	滑阀 Guiding Valve
整机重量(KG) Whole Weight(kg)	51	外形尺寸(MM) Shape Size(mm)	695*425*390
压强 Pressure	流量 Flow(l/min)	额定压力 Rated pressure(MPa)	
低压 Low Pressure	15	7	
高压 High Pressure	2.7	80	



说明 / Explain

- ◆ SY-BQ-80超高压液压泵站, 适用于导线压接施工机具, 我厂在整体结构优化, 全部采用压力油自供给复位, 无传统式弹簧机构。结构紧凑, 造型美观, 重量轻, 质量稳定可靠, 整机性能高。
- ◆ SY-BQ-80 ultra-high pressure hydraulic pumping station is suitable for wire bonding construction equipment. In our plant, the overall structure is optimized, all of which adopt pressure oil self-supply reset, and there is no traditional spring mechanism. Compact structure, beautiful appearance, light weight, stable and reliable quality, high performance of the whole machine.

■ 液压泵 / Hydraulic Pump

产品编号 Item No.	16164	16164A	16164B
产品型号 Model	CP-700	CP-700A	CFP-800B
类型 Type	手动 Hand	手动 Hand	脚踏 Foot Pump
最大输出压力 Max output pressure	低压 Low Pressure 2mpa 高压 High Pressure 70mpa	低压 Low Pressure 2mpa 高压 High Pressure 70mpa	低压 low pressure 2Mpa 高压 high pressure 70Mpa
输出油量 Output of the oil	低压 Low Pressure 13cc 高压 High Pressure 2.3cc	低压 Low Pressure 13cc 高压 High Pressure 2.3cc	低压 low pressure 13cc 高压 high pressure 2.3cc
储油量 Oil capacity	900cc	2700cc	600cc
活塞 Direction of piston	二段式 Double	二段式 Double	二段式 Double
重量(KG)Weight	Approx.N.W9.5KG G.W10.9KG	Approx.N.W14.1KG G.W15.5KG	Approx.N.W9.8KG G.W10.8KG
尺寸(LxWxH) Measurement	700x100x160mm	700x100x200mm	520x160x170mm
包装 Package	纸箱 Paper Box	纸箱 Paper Box	纸箱 Paper Box



产品编号 Item No.	16153-1	16153-2
产品型号 Model	ZCB6-5-AB	ZCB6-5-A3
类型 Type	双回路 Double-acting	单回路 Single-acting
输出功率 Rated Output	750W	750W
电压 Voltage	220W/380W	220W/380W
额定压力 Rated Pressure	70Mpa	70Mpa
流量 Flow Rate	低压 Low Pressure 2.5L/Min 高压 High Pressure 0.52L/min	低压 Low Pressure 2.5L/Min 高压 High Pressure 0.52L/mi
储油量 Oil capacity	8L	8L
频率 Frequency	50-60HZ	50-60HZ
重量(KG)Weight	Approx.N.W26KG G.W30KG	Approx.N.W26.65KG G.W29KG
包装 Package	木箱 Wooden Case	木箱 Wooden Case



说明 / Explain

- ◆ 高低压两段出油量快, 涡轮叶式吸油可达最高有效油量。
- ◆ 压力安全阀过载保护装置避免超载破坏, 超过400kg/cm²时自动泄压。
- ◆ High and low speed two stage design is for quick oil output. Turbine oil absorption could ensure reaching max effective oil volume.
- ◆ Over pressure safety valve unit could avoid over pressure damage. At 700kg/cm², automatically release.

■ 液压冲孔机 / Hydraulic Punching Device

产品编号 Item No.	型号 Model	冲孔力 (KN) Punching force	冲孔厚度 (MM) Punching thickness	喉径 (MM) throat diameter	高度 (MM) Hight	重量 (KG) Weight	标配冲模规格 (MM) specification of matching mold	可配泵 hydraulic pump
06243	CH-60	300	铁6铜10 iron6 copper10	95	350	19	Φ10.5、Φ13.8、 Φ17、Φ20.5	CP-700/ZCB6-5-A3
06244	CH-70	350	铁10铜12 iron10 copper12	110	360	35	Φ10.5、Φ13.8、 Φ17、Φ20.5	CP-700/ZCB6-5-A3
06248	CH-80	500	铁16铜20 iron16 copper20	115	340	45	Φ16、Φ18、 Φ22、Φ25	ZCB6-5-AB
06249	CH-100	1000	铁18铜20 iron18 copper20	135	400	150	Φ25、Φ28、 Φ32、Φ36	ZCB6-5-AB



用途 / Uses

- 用于铜铝排及低碳钢材冲孔，需另配购手动泵或电动泵。
- For copper and aluminum and low carbon steel punching, it needs to be equipped with a hydraulic pump.

说明 / Explain

- 模具尺寸可依客户需求订做。
- The mold size can be customized according to the requirements of the user.

■ 母线加工机 / Hydraulic Bus-bar Machine

产品编号 Item No.	06232	06231
产品型号 Model	EPCB-301	EPCB-401
功能 Function	切排，弯排，冲孔三合一 With three functions, cutting, punching and bending	切排，立弯，平弯，冲孔四合一 With Four functions, cutting, punching and bending(horizontal and erective)
工作台尺寸 Dimension of work table	approx.690x690x730mm	approx.690x690x730mm
电压 Voltage single phase	220V50HZ	220V50HZ
额定压力 Rating oil pressure	700kg/cm ²	700kg/cm ²
弯排出力 Bending force	170KN/200KN	270KN
弯排范围 Bending range	150x10mm max/200x12mm max	125x12.5mm max
切排出力 Cutting force	200KN/300KN	200KN/300KN
切排范围 Cutting range	150x10mm max/200x12mm max	150x10mm max/200x12mm max
冲孔出力 Punching force	300KN/350KN	300KN/350KN
喉深 Distance from hole to sheet side	95x110mm max	95x110mm
冲孔范围 Punch range	Φ10.5mmΦ13.8mm Φ17mmΦ20.5mm	3/8"(Φ10.5mm), 1/2"(Φ13.8mm), 5/8"(Φ17mm),3/4"(Φ20.5mm)
包装 Package	木箱 Wooden Case	木箱 Wooden Case



棘轮扳手 / Ratchet Wrench

产品编号 Item No.	规格 Model	长度(MM) Length	重量(KG) Weight	产品编号 Item No.	规格 Model	长度(MM) Length	重量(KG) Weight
05101	14(M8)、17(M10)	310	0.4	05108	24(M16)、32(M22)	360	0.9
05102	17(M10)、19(M12)	310	0.5	05109	27(M18)、30(M20)	360	0.9
05103	19(M12)、22(M14)	310	0.6	05110	27(M18)、32(M22)	360	0.95
05104	19(M14)、24(M16)	310	0.65	05111	30(M20)、32(M22)	360	1.0
05105	22(M14)、27(M16)	310	0.65	05112	30(M20)、36(M24)	360	1.0
05106	24(M16)、27(M18)	310	0.7	05113	32(M22)、36(M24)	360	1.1
05107	24(M16)、30(M20)	310	0.8				



用途 / Uses

- ◆ 用于紧固六角头螺栓，速度快，使用方便。
- ◆ Apply to tightening hexagonal head bolts speedily and conveniently.

说明 / Explain

- ◆ 规格为六角对边尺寸。
- ◆ The specification refers to the size of opposites of hexagonal head.

尖扳手 / Open-end Wrench with Sharp Tail

产品编号 Item No.	规格 Model	长度(MM) Length	重量(KG) Weight	产品编号 Item No.	规格 Model	长度(MM) Length	重量(KG) Weight
05121	14(M8)	280	0.2	05128	32(M22)	400	1.2
05122	17(M10)	280	0.25	05129	36(M24)	420	1.4
05123	19(M12)	300	0.35	05130	41(M27)	450	1.9
05124	22(M14)	320	0.45	05131	46(M30)	480	2.5
05125	24(M16)	350	0.65	05132	50(M33)	500	3.0
05126	27(M18)	360	0.7	05133	55(M36)	520	3.9
05127	30(M20)	400	1.0	05134	65(M42)	520	4.2



用途 / Uses

- ◆ 用于紧固六角头或方头螺栓。
- ◆ Apply to tightening hexagonal head or square head bolt.

说明 / Explain

- ◆ 规格指六角或方头对边尺寸。
- ◆ The specification refers to the size of opposites of hexagonal head or square head.

双面套筒扳手 / Double Sided Sleeve Wrench

产品编号 Item No.	规格 Model	重量(KG) Weight	产品编号 Item No.	规格 Model	重量(KG) Weight
05135	M16、M18	0.4	05142	M36、M42	1.8
05136	M18、M20	0.4	05143	M42、M48	2.4
05137	M20、M22	0.5	05144	M48、M52	3.0
05138	M22、M24	0.6	05145	M52、M56	3.8
05139	M24、M27	0.8	05146	M56、M60	4.5
05140	M27、M30	0.9	05147	M60、M64	5.0
05141	M30、M36	1.2	05148	M68、M72	6.0



用途 / Uses

- ◆ 用于紧固铁塔地脚螺栓，扭力大，不易松动。
- ◆ Used to fasten the tower anchor bolts, torque, not easy to loose.

■ 接地线 / Grounding Lead

便携式短路接地线依据DL/T879-2004《带电作业用便携式接地和接地短路装置》
Portable short-circuit grounding wire based on DL/T879-2004 standard

用途(Uses): 用于输电线路、发电厂和变电设备停电检修时短路接地。
Used: It is suitable for transmission lines, power plants and substation equipment, short circuit grounding for power outage maintenance.

特点(Feature): 导线端线卡采用铝合金压铸, 强度高导电性能好。
Features: Wire clamber with Aluminum Alloy casting, high strength, good conductivity

短路接地线组采用袋式包装, 便于携带运输。
The portable short-circuit grounding wire is packed in canvas bag, which is easy to carry and transport.

产品编号 Item No. 23012
双舌拉紧式(线路型) Double tongue tension (Transmission line type)

产品编号 Item No. 23011
螺旋压紧式(线路型) Spiral compaction (Transmission line type)

产品编号 Item No. 23001
螺旋压紧式(变电型) Spiral compaction (Substation type)

电压等级 Voltage class	接地软铜线规格 Ground soft copper wire		接地操作棒长度(MM) Length of ground operation rod		
	(MM)	(M)	绝缘部分 Insulating	握手部分 Handheld	总长度 Total length
10KV	25	1*3+7~1.5*3+20	700	300	1000
35KV	25	1.5*3+18	900	600	1500
68KV	25	1.5*3+20	1000	600	1600
110KV	25, 35	9*3 2*3+20	1300	700	2000
220KV	25, 35	9*3 3*3+25	2100	900	3000
330KV	35, 50	12*3 4*3+25	3000	1100	4100
500KV	35, 50	13*3~20*3	4100	1400	5500
220-500KV 架空地线 Overhead ground wire	25	1*3+7~1.5*3+20	700	300	1000
高压试验设备 High pressure test equipment	35, 50	5*3~10*3	700	300	1000

□ 每米接地线的额定负荷 / The rated value of the copper wire per meter

截面积MM ² Sectional area	10	16	25	35	50	70	95	120
线径/MM Wire diameter	4.2	5.7	7.5	8.78	11	12	16	17
外径/MM Sheath diameter	7.3	7.8	9.6	11.2	12.6	16.5	21	22
电阻值/MΩ Resistance value	1.98	1.24	0.79	0.56	0.4	0.28	0.21	0.16
安全载流A Safety current	90	100	123	150	210	238	300	300



■ 个人保安线 / Portable Safety Grounding Wire

产品编号 Item No.	型号 Model	接地线截面积(MM ²) Wire Section	线夹数 Clip Quantity	接地线长度(M) Wire Length
23021	三相 Three-phase	16	4+1	4*0.5+2
23022		25		4*1+3
23031	单相 Single-phase	25	1+1	2*0.3+7.7

用途 / Uses

- 用于防止工作人员在停电线路作业时遭受感应电触电, 防止意外电源入侵的辅助保护措施, 保护工作人员的人身安全。
- Prevent workers from receiving electric shock when they work on the blackout line, serve as auxiliary safeguard to prevent the unexpected electric shock, protect the worker's life safety.



■ 验电器 / Electroscop

产品编号 Item No.	额定电压(KV) Rated Voltage	有效绝缘长度(MM) Effective Insulation Length	伸态(MM) Extension	缩态(MM) Constriction
23106	10	90	1100	230
23107	35	1300	1600	260
23108	110	1300	1600	400
23109	220	2000	3100	460
23109A	330	4000	4500	1000
23109B	500	7000	7500	1500

用途 / Uses

- 用于检验高压线路及设备是否有电, 以保证工作人员作业安全。
- It is used to check whether the high voltage line and equipment have electricity, so as to ensure the safety of the staff.



■ 安全带 / Safety Harness

产品编号 Item No.	产品名称 Product name	负荷(KG) Load	特征 Feature
23063	半身安全带 Half body safety harness	100	
23064	全身安全带 Whole body safety harness	100	
23063A	半身安全带 Half body safety harness	100	带电工围杆带 Girth band
23064A	全身安全带 Whole body safety harness	100	带电工围杆带 Girth band



■ 脚扣 / Grapplers

产品编号 Item No.	规格 Model	适合杆子类型 Pole type	额定负荷(KG) Rated load	适合杆径(MM) Pole diameter	杆长(M) Length
22213	300	变径钢杆水泥杆 Variable diameter Cement Pole steel Pole	150	Φ190-300	8-10
22210	350		150	Φ250-350	10-12
22214	400		150	Φ300-400	12-15
22213A	300	变距木杆 Variable diameter Wood Pole	150	Φ190-300	8-10
22210A	350		150	Φ250-350	10-12
22214A	400		150	Φ300-400	12-15
22213B	280	定径钢杆水泥杆 Equal diameter steel pole cement pole	150	Φ280	10
22210B	300		150	Φ300	12
22214B	350		150	Φ350	15



■ 拉闸杆 / Switch Rod

常规产品参数表 parameter					
额定使用电压 Rated voltage	总长 Total length	节数 Node number	绝缘杆外径 Outer diameter of insulation rod	绝缘杆壁厚 Wall thickness	组接方式 Combining ways
10KV	3M	3	32mm	3.5mm	平口螺旋 Flat mouth spiral
10KV	4M	4	32mm	3.5mm	
35KV	4M	4	32mm	3.5mm	
110KV	4.5M	3	32/37mm	3.5mm	
110KV	5M	4	32/37mm	3.5mm	
220KV	6M	3	32/37mm	3.5mm	
220KV	6M	4	32/37mm	3.5mm	
500KV	8M	4	32/37mm	3.5mm	

额定使用电压 Rated voltage	伸开长度 Total length	节数 Node number	缩回长度 Retraction length	顶部杆粗 Top rod rough	底部杆粗 BottomTop rod rough	组接方式 Combining ways
10KV	3	3	124cm	26mm	38mm	伸缩 Telescopic
10KV	4	3	158cm	26mm	39mm	
35KV	4	4	158cm	26mm	44mm	
110KV	5	4	159cm	26mm	44mm	
110KV	6	4	184cm	26mm	44mm	
220KV	7	4	225cm	26mm	44mm	
220KV	9	4	232cm	26mm	45mm	
500KV	10	5	241cm	26mm	51mm	



■ 软梯头 / Hanging Rope Ladder Inspection Trolleys

产品编号 Item No.	型号 Model	特点 Feature	长度(mm) Length	靠背 Backrest	重量(KG) Weight
22250B	TR-3A	单线 Single line	1.2	无N	4.5
22250B4	TR-3	单线 Single line	1.4	有Y	5
22250S	TR-SP	水平双线配刹车 Horizontal double line with brake	1.4	有Y	5.5
22250SZ	TR-SZ	垂直双线 Vertical double line	1.8	有Y	8
22250Z	TR-ZS	自锁式, 单线配刹车 Self locking, single line with brake	1	无N	5
22250Z1	TR-ZS1	自锁式, 单线配刹车 Self locking, single line with brake	1.4	有Y	6



用途 / Uses

- ♦ 用于架空导线上挂绝缘软梯用。
- ♦ Used for hanging insulation flexible rope on overhead conductors.

■ 绝缘软梯 / Insulated Rope Ladder

产品编号 Item No.	型号规格 Model	边绳材质 Side rope material
22250	Φ12x300	锦纶绳 Nylon rope
22250A		蚕丝绳 Silk rope



说明 / Explain

- ♦ 两侧边绳采用编织法, 内芯为Φ12mm, 一次性编织成H型对穿横档, 横档采用双氧树脂管。
- ♦ The rope in two side use weave method, inner core use Φ12mm, The rung use epoxy resin pipe.

■ 防坠器 / Anti Fall Device

产品编号 Item No.	型号规格 Model	冲击负荷 Impact load	下滑距离 Drop distance	使用寿命 Service life
23105	3、5、7、10、15、20、30、40、50m	100kg	≤0.2m	≥20000次 ≥20000times



■ 安全帽 / Safety Hat

产品编号 Item No.	材质 Material	备注 Remark
23071	ABS	
23071A		带报警 Warning device



■ 绝缘手套、绝缘靴和绝缘鞋 / Insulated Gloves, Shoes, Boots

产品编号 Item No.	额定电压(KV) Rated Voltage	备注 Remark
23072	12	
23073	35	
23075	25	大小尺寸可选 Size size optional
23076	35	
23078	5	大小尺寸可选 Size size optional
23079	15	



23073

23075

■ 测高杆 / Height Measuring Telescopic Rod 产品编号 Item No. 23015

规格 Model	节数 Node number	伸开长度 Extension length	缩回长度 Retraction length	底部手握粗度 Diameter of the handshake	顶部最细一节粗度 Minimum diameter at the top	重量 Weight
5m	4	5m	1.37	36.5	25.5	0.9
6m	5	6m	1.35	36.5	22.5	1
8m	6	8m	1.52	39.5	22.5	1.4
10m	7	10m	1.62	43.5	22.5	1.8
12m	9	12m	1.55	46	19.5	2.25
15m	11	15m	1.65	50.5	16	2.9
18m	13	18m	1.68	54	13.5	3.6
20m	14	20m	1.74	58.5	13.5	4.5



■ 驰度观测仪 / Zoom Sag Scope

产品编号 Item No.	放大倍数 Magnification factor	适用角铁 Applicable angle iron	重量(KG) Weight	备注 Remark
22151	4	∠56-125	1.6	铁塔角钢 Angle steel on the tower
22181			0.5	水泥杆/钢杆 Cement Pole steel Pole
22191			0.6	铁塔角钢 Angle steel on the tower

用途 / Uses

- 适用于平行四边形法、异长法观测驰度，可将经纬仪固定于铁塔角钢上。
22191:塔上固定架
22181:水泥杆固定架
- Apply to observe the sagging by means of the parallelogram method and different length method, can mount the theodolite on the pylon.
22191: Pole Mounting Adapter
22181: Tower Mounting Adapter



■ 导线(电缆)长度测量仪 / Conductor (Cable) Length Measurement

产品编号 Item No.	型号 Model	适用角铁 Applicable angle iron	重量(KG) Weight
22171	CC2000A	Φ50	3

用途 / Uses

- 用于测量导线或电缆展放长度，亦可用，在分裂导线安装间隔棒时测量距离。
- Apply to measure the spreading length of conductor or cable, also can measure bundle conductors distance by setting up spacers.



■ 地锚 / Ground Anchor

产品编号 Item No.	型号 Model	允许拉力(KN) Allowable pull	有效埋深(M) Valid depth	主要尺寸(MM) Main size				重量(KG) Weight
				A	B	C	d	
02120	SDM3	30	1.8	800	250	150	Φ25	22.5
02121	SDM5	50	1.8	900	270	180	Φ28	30
02122	SDM10	100	2.0	1200	290	220	Φ36	55
02123	SDM16	160	2.5	1500	500	258	—	105

用途 / Uses

- 送电线路施工的临时锚固用。
- Apply to anchor temporarily in line construction.
- 使用时将地锚埋入一定深度的地锚坑内，将固定在地锚上的钢丝绳从预先挖好的马道斜向引出，填土夯实后承受载荷。
- Excavate ground anchors pit according to the required depth. Put the anchor in the ground anchors pit. Anchor the anchor rope and the ground anchor, and oblique to the elicitation. When the fill is tamped, it can be used.

■ 地钻 / Earth Drill

产品编号 Item No.	型号 Model	额定负荷(KN) Rated load	破坏负荷(KN) Breaking load	最大深度(MM) Maximum depth	盘径(MM) Disk diameter	总长度(MM) Length	重量(KG) Weight
02101	SDZ1	10	20	1100	Φ250	1300	10.2
02102	SDZ3	30	60	1500	Φ300	1710	14.6
02103	SDZ5	50	100	1500	Φ350	1710	21.0

用途 / Uses

- 用于施工作业时临时性锚固。
- Apply to anchor temporarily in line construction.



■ 压接管保护套-导线 / Splicing Sleeve Protector (ACSR)

产品编号 Item No.	型号 Model	主要尺寸(MM)Main size				适用导线(MAX) Application conductor
		D	L	d	L1	
17201	J240B	Φ45	850	Φ38	530	LGJ240/55
17202	J300B	Φ51	940	Φ43	600	LGJ300/50
17203	J400B	Φ57	995	Φ47	665	LGJ400/50
17204	J500B	Φ68	1080	Φ56	740	LGJ500/65
17205	J630B	Φ83	1180	Φ63	800	LGJ630/55
17206	J720B	Φ83	1196	Φ63	816	LGJ720/55
17207	J900B	Φ89	1180	Φ73	800	LGJ900/75
17208	J1000B	Φ95	1400	Φ75	1020	LGJ1000/80
17209	JBZ1250	Φ114	2280	Φ86	1190	JL1/G2A-1250

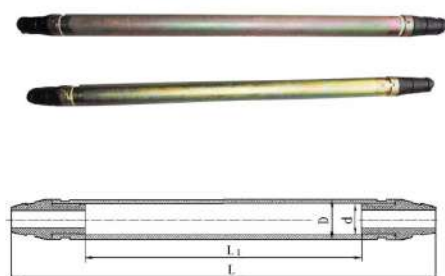

用途 / Uses

- ◆ 适用于在展放钢芯铝绞线时对导线压接管进行保护，使其能顺利通过滑轮不出现弯曲。
- ◆ Apply to protecting wire pressure tube on ACSR releasing and make it avoid torsion when pass through pulleys.

■ 压接管保护套-地线 / Splicing Sleeve Protector (Steel Strand)

产品编号 Item No.	型号 Model	主要尺寸(MM)Main size				适用地线 Application ground wire
		D	L	d	L1	
17213	J55G	Φ30	450	Φ24	280	GJ50、GJ55
17214	J70G	Φ30	510	Φ24	340	JLB65、GJ70
17215	J80G	Φ34	510	Φ27	340	GJ80
17216	J95G	Φ34	585	Φ27	415	JLB95
17217	J100G	Φ38	590	Φ28	390	LGJ50/30、LGJ100
17218	J120G	Φ40	660	Φ30	440	GJ120、JLB120
17219	J150G	Φ45	850	Φ37	530	GJ150、LGJ70/40、LGJ95/55

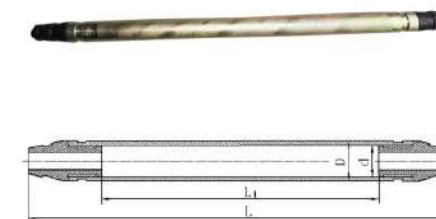

用途 / Uses

- ◆ 适用于再展放钢绞线时，对地线压接管进行保护，使其能顺利通过滑轮不出现弯曲。
- ◆ Apply to protecting the ground wire pressure tube on steel strand releasing and make it avoid torsion when pass through pulleys.

■ 绝缘梯 / Insulated ladder

产品编号 Item No.	产品名称 Product name	型号规格 Model	材质 Material
22248	绝缘单梯 Insulated straight ladder	2、2.5、3、3.5、 4、5、6、7、8m	轻型环氧树脂 Light epoxy resin
22249	绝缘伸缩梯 Insulated telescopic ladder		
22258	绝缘升降梯 Insulated rise-fall ladder		
22259	绝缘人字梯 Insulated A-shape ladder		

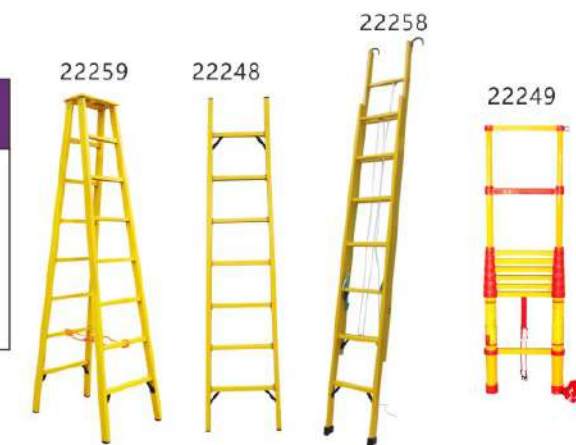

■ 框式作业平台 / Frame work platform

产品编号 Item No.	额定负荷(KN) Rated load	长度(M) Length	重量(KG) Weight
22253	1.5	3	30
22255	1.5	10	100

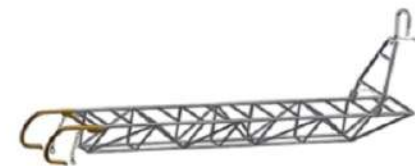

用途 / Uses

- 可用于转角塔挂线作业等。挂梯一头挂在横担角铁上，另一头用吊钩吊在到导线上。
- Apply to hang wires operation. The one head of the ladder hangs on the cross arm angle iron and the other head on the conductor.

■ 高空作业平台 / Aerial work platform

产品编号 Item No.	额定负荷(KN) Rated load	长度(M) Length	截面尺寸(MM) Section size	重量(KG) Weight
22252	1.5	4	350*450	32



用途 / Uses

- 可在耐张塔用于平衡挂线高空压接等。
- on the strain poles for clipping in conductor of aerial compression joining operation, etc.

说明 / Explain

- 载荷超过时，应增加吊绳数并试验。吊绳应拴住底部主材。
- When large load required, more suspension ropes are needed. the platform should be tested before each use. the rope must fasten the under beam.

■ 高空帆布圆筒吊袋 / High-altitude Cylindrical Canvas Bag

产品编号 Item No.	规格 Model	备注 Remark
22261	Φ250×265	标准型吊袋 Standard
22264	Φ300×310	上大下小袋型 Tapered bucket multi-pocket
22264A	Φ400×400	标准型吊袋 Standard



用途 / Uses

- 高空作业时吊运或存放螺栓等，袋口有撑圈。
- Apply to hoist or store bolts, etc in aerial operation. the ring stitched on top retains opening.

说明 / Explain

- 安全载重20kg.
- Safe load is 20kg.

■ 压接管校直器 / Crimping Pipe Straightener

产品编号 Item No.	型号 Model	校直力(KN) straighten force	最大适用导线 Application conductor	最大适用压接管直径 Diameter of splicing sleeves(MM)	外形尺寸(MM) Shape size	重量(KG) Weight
17211	YJZ2	20	LGJ720	Φ60	300*260*507	12



■ 钢桩 / Universal Steel Pile

产品编号 Item No.	型号 Model	直径 Diameter	长度(MM) Length	重量(KG) Weight
02112	GZ40X1200	40	1200	11
02115	GZ50X1400	50	1400	21
02117	GZ60X1500	60	1500	33
02118	<75*6x1500	/	1500	11



用途 / Uses

- 用于施工作业时临时性锚固。
- Apply to anchor temporarily in line construction.

■ 钢芯铝绞线 / Steel core aluminum stranded wire

标称截面 (MM ²) Nominal cross section	根数/直径(MM) Root number/Diameter		计算截面(MM ²) Calculate the cross section			外径 (MM) Outer diameter	计算拉断力 (N) Calculate the breaking force	计算重量 (KG/KM) Calculate the weight
	铝 Aluminum	钢 Steel	铝 Aluminum	钢 Steel	总计 A total of			
25/4	6/2.32	1/2.32	25.36	4.23	29.59	6.96	9290	102.6
35/6	6/2.72	1/2.72	34.86	5.18	40.67	8.16	12630	141.0
50/8	6/3.20	1/3.20	48.25	8.04	56.29	9.60	16870	195.1
50/30	12/2.32	7/2.32	50.73	29.59	80.32	11.60	42620	372.0
70/10	6/3.80	1/3.80	68.05	11.34	79.39	11.40	23390	275.2
70/40	12/2.72	7/2.72	69.73	40.67	110.40	13.60	58300	511.3
95/15	26/2.15	7/1.67	94.39	15.33	109.72	13.61	35000	380.8
95/20	7/4.16	7/1.85	95.14	18.82	113.96	13.87	37200	408.9
95/55	12/3.20	7/3.20	96.51	56.30	152.81	16.00	78110	707.7
120/20	26/2.38	7/1.85	115.67	18.82	134.49	15.07	41000	466.8
120/25	7/4.72	7/2.10	122.48	24.25	146.73	15.74	47880	526.6
120/70	12/3.60	7/3.60	122.15	71.25	193.40	18.00	98370	895.6
150/8	18/3.20	1/3.20	144.76	8.04	152.80	16.00	32860	461.4
150/20	24/2.78	7/1.85	145.68	18.82	164.50	16.67	46630	549.4
150/25	26/2.70	7/2.10	148.86	24.25	173.11	17.10	54110	601.0
150/35	30/2.50	7/2.50	147.26	34.36	181.62	17.50	65020	676.2
185/10	18/3.60	1/3.60	183.22	10.18	193.40	18.00	40880	584.0
185/25	24/3.15	7/2.10	187.04	24.25	211.29	18.90	59420	706.1
185/30	26/2.98	7/2.32	181.34	29.59	210.93	18.88	64320	732.6
185/45	30/2.80	7/2.80	184.73	43.10	227.83	19.60	80190	848.2
210/10	18/3.80	7/3.80	204.14	11.34	215.48	19.00	45140	650.7
210/25	24/3.33	7/2.22	209.02	27.10	236.12	19.98	65990	789.1
210/35	26/3.22	7/2.50	211.73	34.36	246.09	20.38	74250	853.9
210/50	30/2.98	7/2.98	209.24	48.82	258.06	20.86	90830	960.8
240/30	24/3.60	7/2.40	244.29	31.67	275.96	21.60	75620	922.2
240/40	26/3.42	7/2.66	238.85	38.90	277.75	21.66	83370	964.3
240/55	30/3.20	7/3.20	241.27	56.30	297.57	22.40	102100	1108

■ 钢芯铝绞线 / Steel core aluminum stranded wire

标称截面 (MM ²) Nominal cross section	根数/直径(MM) Root number/Diameter		计算截面(MM ²) Calculate the cross section			外径 (MM) Outer diameter	计算拉断力 (N) Calculate the breaking force	计算重量 (KG/KM) Calculate the weight
	铝 Aluminum	钢 Steel	铝 Aluminum	钢 Steel	总计 A total of			
300/15	42/3.00	7/1.67	296.88	15.33	312.21	23.01	68060	939.8
300/20	45/2.93	7/1.95	303.42	20.91	324.33	23.43	75680	1002
300/25	48/2.85	7/2.22	306.21	27.10	333.31	23.76	83410	1058
300/40	24/3.99	7/2.66	300.09	38.90	338.99	23.94	92220	1133
300/50	26/3.83	7/2.98	299.54	48.82	248.36	24.26	103400	1210
300/70	30/3.60	7/3.60	305.36	71.25	376.61	25.20	128000	1402
400/20	42/3.51	7/1.95	406.40	20.91	427.31	26.91	88850	1286
400/25	45/3.33	7/2.22	391.91	27.10	419.01	26.64	95940	1295
400/35	48/3.22	7/2.50	390.88	34.36	425.24	26.82	103900	1349
400/50	54/3.07	7/3.07	399.73	51.86	451.55	27.63	123400	1511
400/65	26/4.42	7/3.44	398.94	65.06	464.00	28.00	135200	1611
500/35	45/3.75	7/2.50	497.01	34.36	531.37	30.00	119500	1642
500/45	48/3.60	7/2.80	488.58	43.10	531.68	30.00	128100	1688
500/65	54/3.44	7/3.44	501.88	65.06	566.94	30.96	154000	1897
630/45	45/4.20	7/2.80	623.45	43.10	666.55	33.60	148700	2060
630/55	48/4.12	7/3.20	639.92	56.30	696.22	34.32	164400	2209
630/80	54/3.87	19/2.32	635.19	80.32	715.51	34.82	192900	2388
720/50	45/4.529	7/3.02	725.1	50.14	775.24	36.23	170600	2401
800/55	45/4.80	7/3.20	814.30	56.30	870.60	38.40	191500	2690
800/70	48/4.63	7/3.60	808.15	71.25	879.40	38.58	207000	2791
800/100	54/4.33	19/2.60	795.17	100.88	896.05	38.98	24110	2991
900/40	72/3.99	7/2.66	900	38.9	939	39.9	193780	2790
900/75	84/3.69	7/3.69	900	75.0	975	40.6	231750	3074
1000/45	72/4.21	7/2.80	1000	43.2	1043	42.1	220930	3100
1120/50	72/4.45	19/1.78	1120	47.3	1167	44.5	247700	3465
1120/90	84/4.12	19/2.47	1120	91.2	1121	45.3	307790	3812
1250/50	72/4.70	19/1.88	1250	52.8	1303	47.0	269140	3867
1250/70	76/4.58	19/2.14	1250	68	1320	47.34	289860	3999
1250/100	84/4.35	19/2.61	1250	102	1352	47.9	330290	4254

■ LJ型铝绞线 / LJ type aluminium stranded wire

标称截面(MM ²) Nominal cross section	根数/直径 (MM) Root number/ Diameter	计算截面(MM ²) Calculate the cross section	外径 (MM) Outer diameter	计算拉断力(N) Calculate the breaking force	计算重量 (KG/KM) Calculate the weight	标称截面(MM ²) Nominal cross section	根数/直径 (MM) Root number/ Diameter	计算截面(MM ²) Calculate the cross section	外径 (MM) Outer diameter	计算拉断力(N) Calculate the breaking force	计算重量 (KG/KM) Calculate the weight
16	7/1.70	15.89	5.10	2840	43.5	185	19/3.50	182.80	17.50	28440	503.0
25	7/2.15	25.41	6.45	4355	69.6	210	19/3.75	209.85	18.75	32260	577.4
35	7/2.50	34.36	7.50	5760	94.1	240	19/4.00	238.76	20.00	36260	656.9
50	7/3.00	49.48	9.00	7930	135.5	300	37/3.20	297.57	22.40	46850	820.4
70	7/3.60	71.25	10.80	10950	195.1	400	37/3.70	397.83	25.90	61150	1097
95	7/4.16	95.14	12.48	14450	260.5	500	37/4.16	502.90	29.12	76370	1387
120	19/2.85	121.21	14.25	19420	333.5	630	61/3.63	631.30	32.67	91940	1744
150	19/3.15	148.07	15.75	23310	407.4	800	61/4.10	805.36	36.90	115900	2225

■ JLHA2型铝合金绞线 / JLHA2 aluminum alloy strand

标称截面(MM ²) Nominal cross section	根数/直径 (MM) Root number/ Diameter	计算截面(MM ²) Calculate the cross section	外径 (MM) Outer diameter	计算拉断力(N) Calculate the breaking force	计算重量 (KG/KM) Calculate the weight	标称截面(MM ²) Nominal cross section	根数/直径 (MM) Root number/ Diameter	计算截面(MM ²) Calculate the cross section	外径 (MM) Outer diameter	计算拉断力(N) Calculate the breaking force	计算重量 (KG/KM) Calculate the weight
75	7/3.63	72.50	10.90	21390	198.3	360	37/3.53	363.00	24.7	106950	998.9
120	19/2.78	115.00	13.90	33950	316.3	465	37/3.98	460.00	27.9	135810	1268.4
145	19/3.10	144.00	15.5	42440	395.4	520	37/4.22	518.00	29.6	152790	1426.9
185	19/3.51	184.00	17.6	54320	506.1	580	37/4.45	575.00	31.2	169760	1585.5
230	19/3.93	230.00	19.6	67910	632.7	650	61/3.67	645.00	33.0	190140	1778.4
300	19/4.39	288.00	22.0	84880	790.8	720	61/3.89	725.00	35.0	213900	2000.7

■ GJ型镀锌钢绞线 / GJ type galvanized steel stranded wire

标称截面(MM ²) Nominal cross section	外径 (MM) Outer diameter	股数×线股直径 (MM) Number of shares× Stock line diameter	计算截面(MM ²) Calculate the cross section	公称抗拉强度 (Mpa) Nominal tensile strength					计算重量 (KG/KM) Calculate the weight
				1100	1250	1400	1550	1700	
				钢丝破断拉力总和 (KN) 不小于 The total breaking tension of wire is not less than					
GJ-25	6.6	7x2.2	26.6	29.26	33.25	37.24	41.23	45.22	227.7
GJ-35	7.8	7x2.6	37.15	40.87	46.44	52.01	57.58	63.16	318.2
GJ-50	9.0	7x3.0	49.46	54.41	61.83	69.24	76.66	84.08	423.7
GJ-50	9.0	19x1.8	48.32	53.15	60.40	67.65	74.90	82.14	411.1
GJ-70	11.0	19x2.2	72.19	79.41	90.24	101.07	111.89	122.72	615.0
GJ-100	13.0	19x2.6	100.83	110.91	126.04	141.16	156.29	171.41	859.4
GJ-120	14.0	19x2.8	116.93	128.62	146.16	163.70	181.24	198.78	995.0
GJ-120	14.0	37x2.0	116.18	127.80	145.23	162.65	180.08	197.51	981.0
GJ-135	15.0	19x3.0	134.24	147.66	167.80	187.94	208.07	228.21	1144.0
GJ-135	15.5	37x2.2	140.58	154.64	175.73	196.81	217.90	238.99	1187.0

■ 铝包钢绞线 (YB/T 124-1997) / Aluminium clad steel capstan (YB/T 124-1997)

标称截面(MM ²) Nominal cross section	结构根数/单丝直径 (MM) Number of structural roots/diameter of single filament	公称直径(MM) Nominal diameter	计算截面(MM ²) Calculate the cross section	20AC			27AC			30AC		
				最小计算破断拉力 (KN) Minimum calculated breaking tension			计算重量 (KG/KM) Calculate the weight					
20	7/2.00	6.00	21.99	11.37	8.99	7.55	146.35	131.29	124.57			
30	7/2.30	6.90	29.08	35.07	27.75	23.30	193.58	173.57	164.80			
35	7/2.60	7.80	37.17	44.82	35.46	29.77	247.38	221.86	210.62			
40	7/2.75	8.25	41.58	50.14	39.66	33.30	276.72	248.16	235.57			
45	7/2.90	8.70	46.24	55.76	44.11	37.04	307.76	276.01	262.01			
50	7/3.00	9.00	49.48	59.67	47.20	39.63	329.32	295.38	280.33			
55	7/3.20	9.60	56.30	67.89	53.71	45.09	374.71	336.04	319.00			
65	7/3.50	10.50	67.35	79.40	62.43	52.73	448.24	402.00	381.57			
75	7/3.75	11.25	77.31	87.67	70.97	58.45	514.55	461.46	438.06			
70	19/2.20	11.00	72.23	87.10	68.90	57.85	482.61	432.91	410.94			
80	19/230	11.50	78.94	95.20	75.31	63.23	527.50	472.98	449.09			
100	19/2.60	13.00	100.88	121.66	96.24	80.80	674.12	604.57	573.93			
115	19/2.75	13.75	112.85	136.10	107.66	90.39	754.07	676.24	641.94			
120	19/2.85	14.25	121.21	146.18	115.63	97.07	809.94	726.33	689.53			
125	19/2.90	14.50	125.50	151.35	119.73	100.52	838.65	752.14	714.00			
150	19/3.15	15.75	148.07	178.57	141.26	118.60	989.50	887.39	842.31			
180	19/3.50	17.50	182.80	215.52	169.46	143.13	1221.46	1095.46	1039.79			
210	19/3.75	18.75	209.85	237.97	192.64	158.65	1402.20	1257.49	1193.72			
240	19/4.00	20.00	238.76	260.01	191.25	156.87	1595.42	1430.89	1358.25			
195	37/2.60	18.20	196.44	236.91	187.41	157.35	1320.52	1184.28	1124.27			
245	37/2.90	20.30	244.39	294.74	233.15	195.76	1642.82	1473.37	1398.64			
295	37/3.20	22.40	297.57	358.87	283.88	238.35	2000.22	1793.78	1702.83			
350	37/3.50	24.50	355.98	419.70	330.00	287.73	2392.72	2145.90	2036.83			
420	37/3.80	26.60	419.62	468.30	377.66	309.68	2820.69	2529.71	2401.02			
465	37/4.00	28.00	464.72	506.34	405.91	330.58	3125.25	2802.95	2660.67			
510	37/4.20	29.40	512.61	544.40	438.28	364.47	3445.66	3090.15	2933.15			
590	37/4.50	31.50	588.46	598.46	487.24	402.51	3955.53	3547.18	3367.16			
670	37/4.80	33.60	669.54	662.84	536.30	439.89	4500.50	4035.92	3831.36			

■ 8.7/10kV交联聚乙烯绝缘单芯PVC护套电力电缆 (YJV型) /
8.7/10kv cross-linked polyethylene insulated single-core PVC sheathed power cable (YJV type)

标称截面(MM ²) Nominal cross section	导体直径(MM) The conductor diameter	绝缘厚度(MM) Insulation thickness	护套厚度 (MM) The thickness of the sheath	电缆外径(MM) Cable diameter	电缆重量 (KG/KM) Cable weight	标称截面(MM ²) Nominal cross section	导体直径(MM) The conductor diameter	绝缘厚度(MM) Insulation thickness	护套厚度 (MM) The thickness of the sheath	电缆外径(MM) Cable diameter	电缆重量 (KG/KM) Cable weight
1x25	6.0	4.5	1.8	22	650	1x150	14.6	4.5	1.9	31	2000
1x35	7.0	4.5	1.8	23	770	1x185	16.2	4.5	2.0	33	2350
1x50	8.3	4.5	1.8	24	910	1x240	18.4	4.5	2.1	35	2950
1x70	10.0	4.5	1.8	26	1150	1x300	20.6	4.5	2.1	37	3600
1x95	11.6	4.5	1.8	28	1450	1x400	23.8	4.5	2.2	41	4450
1x120	13.0	4.5	1.9	29	1700						

■ 8.7/10kV交联聚乙烯绝缘三芯钢带铠装PVC护套电力电缆 (YJV22型) /

8.7/10kv cross-linked polyethylene insulated three-core steel belt armored PVC sheathed power cable (YJV22 type)

标称截面(MM ²) Nominal cross section	导体直径 (MM) The conductor diameter	绝缘厚度(MM) Insulation thickness	护套厚度(MM) The thickness of the sheath	电缆外径(MM) Cable diameter	电缆重量(KG/KM) Cable weight
3×25	6.0	4.5	2.5	49	3150
3×35	7.0	4.5	2.6	51	3550
3×50	8.3	4.5	2.7	55	4150
3×70	10.0	4.5	2.8	59	4950
3×95	11.6	4.5	2.9	62	5950
3×120	13.0	4.5	3.1	66	6950
3×150	14.6	4.5	3.2	70	8000
3×185	16.2	4.5	3.3	74	9300
3×240	18.4	4.5	3.5	79	11300
3×300	20.6	4.5	3.7	86	14300
3×400	23.8	4.5	3.9	94	17350

■ 26/35kV交联聚乙烯绝缘单芯PVC护套电力电缆 (YJV型) /

26/35kv cross-linked polyethylene insulated single core PVC sheathed power cable (YJV type)

标称截面(MM ²) Nominal cross section	导体直径 (MM) The conductor diameter	绝缘厚度(MM) Insulation thickness	护套厚度(MM) The thickness of the sheath	电缆外径(MM) Cable diameter	电缆重量(KG/KM) Cable weight
1×50	8.3	10.5	2.1	38	1600
1×70	10.0	10.5	2.2	39	1900
1×95	11.6	10.5	2.2	41	2200
1×120	13.0	10.5	2.3	43	2500
1×150	14.6	10.5	2.4	44	2850
1×185	16.2	10.5	2.4	46	3250
1×240	18.4	10.5	2.5	48	3900
1×300	20.6	10.5	2.6	51	4550
1×400	23.8	10.5	2.7	54	5500

■ 26/35kV交联聚乙烯绝缘三芯钢带铠装PVC护套电力电缆 (YJV22型) /

26/35kv cross-linked polyethylene insulated three-core steel tape armored PVC sheathed power cable (YJV22 type)

标称截面(MM ²) Nominal cross section	导体直径 (MM) The conductor diameter	绝缘厚度(MM) Insulation thickness	护套厚度(MM) The thickness of the sheath	电缆外径(MM) Cable diameter	电缆重量(KG/KM) Cable weight
3×50	8.3	10.5	3.7	86	8500
3×70	10.0	10.5	3.8	91	9550
3×95	11.6	10.5	4.0	94	10750
3×120	13.0	10.5	4.1	98	11900
3×150	14.6	10.5	4.2	102	13150
3×185	16.2	10.5	4.3	105	14600
3×240	18.4	10.5	4.5	111	16850
3×300	20.6	10.5	4.6	116	19200
3×400	23.8	10.5	4.9	124	22550

■ 110kV交联聚乙烯绝缘皱纹铝套聚乙烯电力电缆(YJLW03型)/

110kV crosslinked polyethylene insulated corrugated aluminum sheathed polyethylene power cable (YJLW03 type)

标称截面(MM ²) Nominal cross section	导体外径(MM) Conductor diameter	内屏蔽厚度 Inner screen thickness	绝缘厚度(MM) Insulation thickness	外屏蔽厚度 Outside wall thickness	铝套厚度 Aluminium sheath thickness	外护套厚度(MM) Jacket thickness	电缆外径(MM) Cable diameter	电缆重量(KG/KM) Cable weight
240	18.4	1.5	19.0	1.0	2.5	4.0	79.8	8063
300	20.7	1.5	18.5	1.0	2.5	4.0	81.1	8720
400	23.2	1.5	17.5	1.0	2.5	4.0	81.5	9462
500	27.0	1.5	17.0	1.0	2.5	4.0	85.2	10839
630	30.5	1.5	16.5	1.0	2.5	4.0	86.7	12102
800	34.0	1.5	16.0	1.0	2.5	4.0	89.1	13908
1000	38.0	1.5	16.0	1.0	2.5	4.0	93.1	16125
1200	41.7	1.5	16.0	1.0	2.5	4.0	96.8	18310
1400	45.0	1.5	16.0	1.0	2.5	4.0	100.0	20452
1600	48.2	1.5	16.0	1.0	2.5	4.0	103.3	22443

■ 220kV交联聚乙烯绝缘皱纹铝套聚乙烯护套电力电缆(YJLW03型)/

220kV crosslinked polyethylene insulated corrugated aluminum sleeve polyethylene sheath power cable (YJLW03 type)

标称截面(MM ²) Nominal cross section	导体外径(MM) Conductor diameter	绝缘层直径(MM) Insulation layer diameter	电缆外径(MM) Cable diameter	电缆重量(KG/KM) Cable weight
400	23.5	81.5	120.9	14036
500	26.6	87.0	124.1	15454
630	30.0	88.4	125.5	16855
800	34.0	90.4	127.7	18666
1000	38.5	93.4	132.6	21094
1200	42.1	97.1	136.5	23428
1400	45.5	100.5	140.1	25722
1600	48.7	103.6	143.4	27985
1800	51.9	106.9	147.5	30571
2000	54.7	109.7	150.5	32794
2200	57.4	112.3	153.1	34955
2500	61.1	116.1	157.3	38256

■ 10-20kV铝芯交联聚乙烯架空绝缘电缆 (JKLYJ) /

10-20kv aluminum core crosslinked polyethylene overhead insulated cable (JKLYJ)

规格(MM ²) specifications	紧压导体外径 (MM) The outer diameter of a compact conductor	绝缘厚度(MM) Insulation thickness		电缆外径(MM) Cable diameter	
		10kV	20kV	10kV	20kV
25	6.0	3.4	5.5	14.2	18.2
35	7.0			15.2	19.2
50	8.3			16.5	20.2
70	10.0			18.2	22.0
95	11.6			20.0	23.7
120	13.0			21.4	25.2
150	14.6			23.0	26.7
185	16.2			24.6	28.3
240	18.4			26.8	30.6
300	20.6			28.6	32.8

■ 钢丝绳(BG/T20118-2006)/ Steel wire rope (BG/ t20118-2006)

钢丝绳结构: 6×19+FC

钢丝绳公称直径D(MM) Wire rope nominal diameterD	钢丝绳近似重量(KG/100M) The wire rope approximates weight	钢丝绳公称抗拉强度 Mpa				钢丝绳公称直径D(MM) Wire rope nominal diameterD	钢丝绳近似重量(KG/100M) The wire rope approximates weight	钢丝绳公称抗拉强度 Mpa			
		1570	1670	1770	1870			1570	1670	1770	1870
		钢丝绳最小破断拉力(KN)						钢丝绳最小破断拉力(KN)			
4	5.62	7.71	8.20	8.69	9.19	6.2	13.5	17.8	18.9	20.0	21.1
5	8.78	12.0	12.8	13.6	14.4	7.7	21.1	29.3	31.2	33.1	35.0
6	12.6	17.4	18.5	19.6	20.7	9.3	30.5	42.2	45.0	47.6	50.3
7	17.2	23.6	25.1	26.6	28.1	12.5	54.1	75.1	79.9	84.7	89.4
8	22.5	30.8	32.8	34.8	36.7	15.5	85	117	125	132	140
9	28.4	39.0	41.6	44.0	46.5	17.0	102	142	151	160	169
10	35.1	48.2	51.3	54.4	57.4	21.5	165	230	245	259	274
11	42.5	58.3	62.0	65.8	69.5						
12	50.5	69.4	73.8	78.2	82.7						
13	59.3	81.5	86.6	91.8	97.0						
14	68.8	94.5	100	107	113						
16	89.9	123	131	139	147						
18	114	156	166	176	186						
20	140	193	205	217	230						
22	170	233	248	263	278						
24	202	278	295	313	331						
26	237	326	346	367	388						
28	275	378	402	426	450						
(30)	316	434	461	489	517						
32	359	494	525	557	588						
(34)	406	557	593	628	664						

说明 / Explain

◆ 斜体部分规格为标准中没有但实际使用的品种, 其数据为换算值供参考。 ◆ The partial specifications of italics are not found in the standard but are actually used, and the data are converted values for reference.

■ 钢丝绳(BG/T20118-2006)/ Steel wire rope (BG/ t20118-2006)

钢丝绳结构: 6×37+FC

钢丝绳公称直径D(MM) Wire rope nominal diameterD	钢丝绳近似重量(KG/100M) The wire rope approximates weight	钢丝绳公称抗拉强度 Mpa				钢丝绳公称直径D(MM) Wire rope nominal diameterD	钢丝绳近似重量(KG/100M) The wire rope approximates weight	钢丝绳公称抗拉强度 Mpa			
		1570	1670	1770	1870			1570	1670	1770	1870
		钢丝绳最小破断拉力(KN)						钢丝绳最小破断拉力(KN)			
6	12.5	16.7	17.7	18.8	19.9	18	112.0	150.0	160.0	169.0	179.0
7	17.0	22.7	24.1	25.6	27.0	20	138.0	185.0	197.0	209.0	221.0
8	22.1	29.6	31.5	33.4	35.3	22	167.0	224.0	238.0	253.0	267.0
9	28.0	37.5	39.9	42.3	44.7	24	199.0	267.0	284.0	301.0	318.0
10	34.6	46.3	49.3	52.2	55.2	26	234.0	313.0	333.0	353.0	373.0
11	41.9	56.0	59.6	63.0	66.7	28	271.0	363.0	386.0	409.0	432.0
12	49.8	66.7	70.9	75.2	79.4	30	311.0	417.0	443.0	470.0	496.0
13	58.5	78.3	83.3	88.2	93.2	32	354.0	474.0	504.0	535.0	565.0
14	67.8	90.8	96.6	102.0	108.0	34	400	535.0	570.0	604.0	638.0
16	88.6	119.0	126.0	134.0	141.0						

■ 导线模具规格对照表

导线	铝模(L)	钢模(G)	导线	铝模(L)	钢模(G)
LGJ95/15	26	14	LGJ300/40	40	16
LGJ95/20	26	14	LGJ300/50	40	18
LGJ95/55	32	20	LGJ300/70	42	22
LGJ120/7	26		LGJ400/20	45	14
LGJ120/20	26	14	LGJ400/25	45	14
LGJ120/25	26	14	LGJ400/35	45	16
LGJ120/70	34	22	LGJ400/50	45	20
LGJ150/8	32		LGJ400/65	48	22
LGJ150/20	32	14	LGJ400/95	48	26
LGJ150/25	32	14	LGJ500/35	52	16
LGJ150/35	32	16	LGJ500/45	52	18
LGJ185/10	34	14	LGJ500/65	52	22
LGJ185/25	34	14	LGJ630/45	60	18
LGJ185/30	34	16	LGJ630/35	60	20
LGJ185/45	34	18	LGJ630/80	60	24
LGJ240/30	36	16	LGJ800/55	65	20
LGJ240/40	36	16	LGJ800/70	65	22
LGJ240/55	36	20	LGJ800/100	65	26
LGJ300/15	40	14	LQJQT1400	76	30
LGJ300/20	40	14	NAHLQJQ1440	80	34
LGJ300/25	40	14			

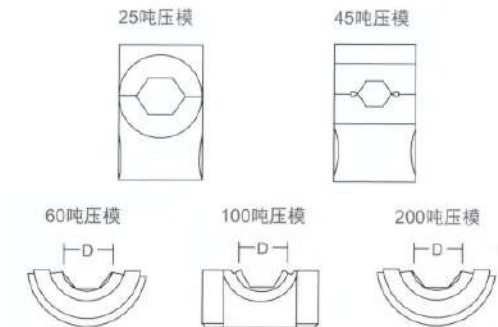

■ 钢绞线压接模具规格参照表

压接管外径(mm)	规格
Φ14	GJ-25
Φ16	GJ-35
Φ18	GJ-50
Φ22	GJ-70
Φ24	GJ-80
Φ26	GJ-100
Φ28	GJ-120
Φ30	GJ-135
Φ34	GJ-150
Φ35	GJ-165

■ 端子与设备线夹压接外径参考尺寸

标准截面(mm)	10	16	25	35	50	70	95	120	150	185
铜端子外径(mm)	8	9	10	12	14	16	18	21	23	25
铝端子外径(mm)	9	10	12	14	16	18	21	23	25	27
设备线夹外径(mm)	----	----	----	16	18	22	16	26	28/30	32/34

标准截面(mm)	240	300	400	500	630	720	800	1000	1140	1440
铜端子外径(mm)	27	31	34	38	45	----	50	56	----	----
铝端子外径(mm)	31/30	34	38/40	47	54	----	60	----	----	----
设备线夹外径(mm)	36	40	45	52	60	65	65	76	90	100